



1946

**CUTTING
EQUIPMENT**

**2019
GENERAL CATALOGUE**



CUTTING EQUIPMENT

Rasor Elettromeccanica S.r.l.
Via Vincenzo Caldesi 6
20161 Milan, Italy

Phone
(+39) 02 662 21 231

Fax
(+39) 02 662 21 293

Email
info@rasor-cutters.com

www.rasor-cutters.com



ABOUT US



Rasor Elettromeccanica Srl was born in Milan in 1946 by founder Mr. Luigi Spinelli that with his inborn talent in technical and precision mechanics matters and exceptional ability successfully realized the first wholly hand-made bench cutter.

Rasor's products were firstly born for the application in textile industry while now the range has been enlarged to industries for technical textile and composite material production.

The distinctiveness of Rasor is the wholly inside work to start with design of the product, production, packaging, delivery. All thanks to workers professionally grown up together with the Company being in perfect agreement with the founder with the sole target to grant quality of each single produced cutter.

That is still the key point of Rasor and so to be daily engaged with any improvement and open to study and develop new materials and technologies.

Rasor boast an international network of distributors to be successfully present on all the Continents.

As of today Rasor Elettromeccanica Srl boast the professional continuity of two generation yet with the strong experience got by the founder thanks to his passion and devotion.

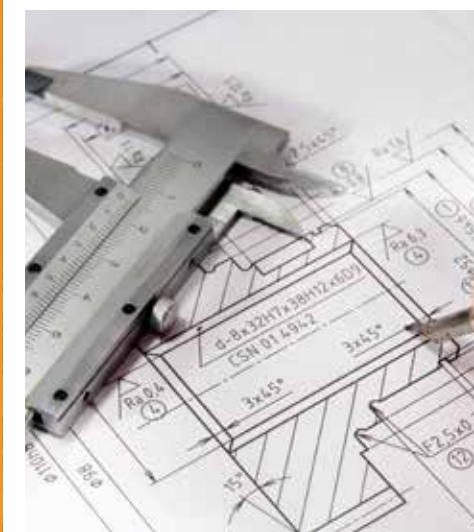

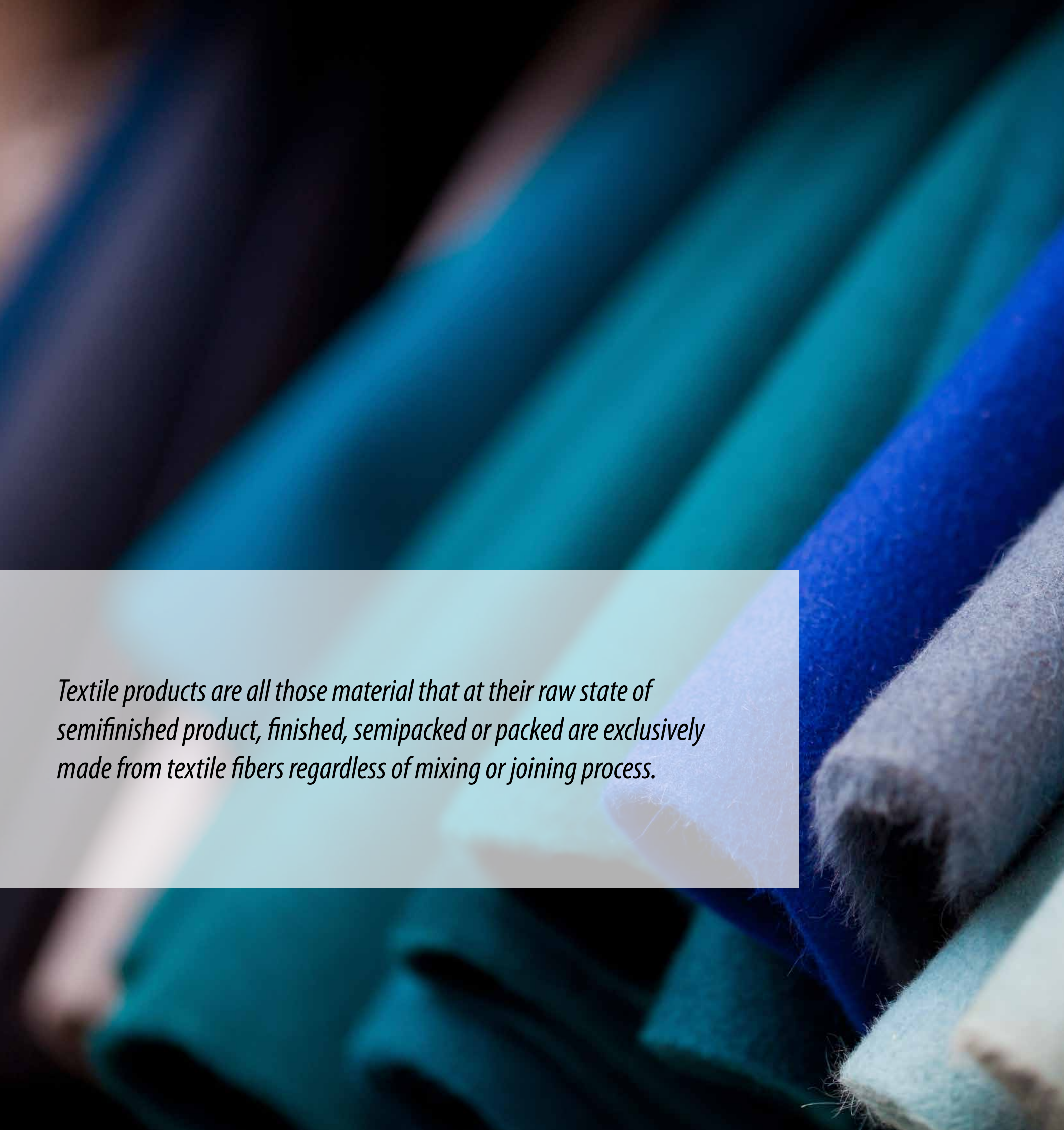

Textile products are all those material that at their raw state of semifinished product, finished, semipacked or packed are exclusively made from textile fibers regardless of mixing or joining process.



TEXTILE



In 1946 Rasor produce the first bench cutters for the cloth industry, leather industry and furniture industry.

For 70 years over 35000 units have been sold all over the world to textile laboratories and tannery.

The engagement of Rasor for the textile industry go forward with the introduction of cutters more and more versatile, light and step by step with the progress of technology and design.





A technic fabric is a fabric not produced for appearance purpose but for fabric feature itself. The application field of technic fabric is rapidly growing up also as support of a wide range of many other industrial fields.



TECHNICAL

TEXTILE



The world growing rate of technic fabric production is about 4%/year compared with the growing of typical fabrics. The importance of development of technic fabric materials is on an equal footing with the industry's more and more requirements.

As of today the relatively most common technic fabric materials are applied in the following fields:

Agrotech, Mobiltech, Buildtech, Clothtech, Geotech, Hometech, Mobiltech, Oekotech, Packtech, Sporttech

In the latest years Rasor have developed technologies and experience to satisfy any requirement to cut technic fabrics with over 10 models within their range of electrical or pneumatic, hand-held or OEM cutting units.



The composite material is basically a material made of combination of more different simple materials. The ensemble of all the simple materials make a product able to guarantee very high mechanical properties with very low expansion of mass. This is why the composite material are widely used in application where key point is lightness.

COMPOSITE



The composite material are required in production fields where it is necessary to satisfy the need to keep light weight with high mechanical properties.

Particularly the aerospace, naval and automotive industries widely use composite material for the construction of wings structures, fuselages, trailers, boats, canoes, cars' panels, frames for Formula One cars, springs, engine parts and other accessories. The aerospace and warlike industries use composite material respectively for construction of components for space station and space vehicles and for construction of helmet and bullet-proof vest.

In the sport filed the composite material are applied for the construction of skies, bob-sleds, tennis rackets, bicycles, fishing rods, risers for archery and sticks for the high jump.

In medical field the composite material are applied for construction of prosthesis while in the plant construction composite material are used for pipes and tanks construction.

In the latest five years Rasor has focused their know-how and experience in the development of cutting tools especially made for composite material cut. Most of the many producers/ end users of composite material have standardized Rasor tools for their cutting process.





TEXTILE



TECHNICAL TEXTILE



COMPOSITE

| | TEXTILE | TECHNICAL TEXTILE | COMPOSITE |
|-------------------------|---------|-------------------|-----------|
| Battery Driven Scissors | | | |
| Nera (pag. 15) | • | | |
| Zero702 (pag. 17) | • | • | • |
| Electric Hand Shears | | | |
| DS504 (pag. 21) | • | • | |
| DS503MT (pag. 22) | • | • | |
| OPTIMA 703 (pag. 23) | • | • | • |
| Pneumatic Hand Shears | | | |
| FP503 (pag. 27) | • | • | |
| FP503MT (pag. 28) | • | • | • |
| FP702 (pag. 29) | • | • | |
| FP862 (pag. 30) | • | • | • |
| FP862MT (pag. 31) | | | • |
| FP861RC (pag. 32) | • | | |
| Electric Bench Cutters | | | |
| D86 (pag. 35) | • | | |
| D100 (pag. 36) | • | | |
| D86P2 (pag. 37) | • | • | |
| SW100 (pag. 38) | • | • | |
| SW12 (pag. 39) | • | • | |
| SW12M (pag. 40) | | • | • |
| Pneumatic Cutting Units | | | |
| FP861V2 (pag. 43) | • | • | |
| FP861A2 (pag. 44) | • | • | |
| FP100 (pag. 45) | • | • | |
| FP100L (pag. 46) | • | • | |
| FP120M (pag. 47) | • | • | • |
| FP120SM (pag. 48) | • | • | • |
| FP120DT (pag. 49) | • | • | • |

| | TEXTILE | TECHNICAL TEXTILE | COMPOSITE |
|------------------------------------|---------|-------------------|-----------|
| Single phase Cutting Units | | | |
| D86PS2 (pag. 53) | • | • | |
| SW100S (pag. 54) | • | • | |
| SW100SL (pag. 55) | • | • | |
| SW12S (pag. 56) | • | • | |
| SW12SSX (pag. 57) | • | • | |
| SW12SM (pag. 58) | • | • | • |
| SW12SSM (pag. 59) | • | • | • |
| 3-phases Cutting Units | | | |
| GRT-MINI (pag. 63) | • | • | |
| GRT-MINIV (pag. 64) | • | • | |
| GRT10 (pag. 65) | • | • | |
| GRT10L (pag. 66) | • | • | |
| GRT12 (pag. 67) | • | • | |
| GRT12SX (pag. 68) | • | • | |
| GRT12M (pag. 69) | | • | • |
| GRT12SM (pag. 70) | | • | • |
| GRT12DT (pag. 71) | | • | • |
| 3-phases DirectDrive Cutting Units | | | |
| DD120MR (pag. 75) | • | • | • |
| DD120ML (pag. 76) | • | • | • |
| DD120DT (pag. 77) | • | • | • |
| Accessories | | | |
| BLADES & MODELS (pag. 80) | | | |
| BLADES (pag. 82) | | | |
| ACCESSORIES & MODELS (pag. 84) | | | |
| ACCESSORIES (pag. 86) | | | |
| Dealers (pag. 88) | | | |



**ZERO CORD
ZERO PROBLEMS
MAXIMUM POWER**

Battery driven scissors

Nera

580g BATTERY DRIVEN SCISSORS



FEATURES

- UNIQUE MACHINE 580 g ONLY (INCLUDING BATTERY)
- HIGH SPEED GEARS 900 RPM
- STRENGTHENED STRUCTURE
- NEW INTEGRATED SHARPENING DEVICE
- REMOVABLE LI-ION® BATTERY

ACCESSORIES INCLUDED
AVAILABLE IN EU OR US
PLUG



Li-Ion®
Technology

NEW ELECTRIC SCISSOR. POWERFUL, LIGHT, EASY.

Nera

580g BATTERY DRIVEN SCISSORS

APPLICATIONS
TEXTILE



Check the product
on our website



SPECIFICATIONS

Blade diameter: 50 mm (1.96") with hard metal counterblade
Blade descr.: 503EEXT, 6-edge EXTRA steel
Blade speed: 900 r.p.m.
Cutting ability: 9 mm (0.35")
Power: 3.7 V, 35 W
Battery: 3.7 V Li-Ion®, 2.4 Ah rechargeable with charge status indicator LED
Charger: 100-240VAC, 50/60 Hz, 0.4A max – Output: 4.2V, 2A
Recharging time: 4 h
Weight (with battery): 580 g Total
Weight (with packing box) 950 g
Minimum brightness for working operations: LUX 200
Vibrations at start up < 2.5 m/sec²
Temperature range 0° – 55° C
Umidity range 10 – 95% without condensate

SAFETY

Safety start/stop device system
 Heigh-adjustable trasparent fore blade protection

DESCRIPTION

The new model NERA504 is the revolutionary hand held battery driven shear for any kind of textil fiber. Unique on the market it combines the cutting potentiality of the model DS504 with a miniature Lithium-Ion 3.7V battery-powered motor. The result is a compact, powerful and reliable cutting machine in just 580 grams of weight. Never has a cutting tool had this excellent weight/performance ratio. The reinforced structure and coupling gear of bronze / steel material generate 900 rpm, unique on the market of its kind to obtain this speed allowing its use not only in the textile field but also in the field of light technical fabrics and light leathers. The Lithium Ion battery develops 2400 mAh and is easily rechargeable with the appropriate docking station with LED indicator. The second battery, included in the box, allows a quick replacement so to cut continuously without interrupting the work. The maximum cutting thickness is 9 mm and the new button sharpener allows to revive the cutting edge of the blade in less than ten seconds without removing it. The cutting foot, strong and with a thin shape, allows the cutting of curved profiles with great ease. The new NERA is truly an innovative concentrate of power, lightness and ease of use in the field of professional cutting tools.



ACCESSORIES

Special Feet F5070A, F5070B
Batteries BAT36
Chargers DK36, CH36, CH3601
Rail G30-04
Trailers C30-04, C30-0401, C30-0402

Stopper S30-04
Blocking Pins F5057
Butterfly Keys F5059
Gear Grease T107900, T107901
Metal Gloves GMT-REV

BLADES Ø 50 MM



APPLICATIONS
TEXTILE
TECHNICAL TEXTILE
COMPOSITE



Check the product
on our website



Li-Ion® Technology



Speed regulator



DESCRIPTION

Zero702 is the first hand-held battery driven cutting tool for professional and stepless production process. It is made as combination of the cutting body of the already approved OPTIMA 702 and the innovative and modern battery driven motor. It weighs only 1900 grams (battery included) and develop a power of 400Watt which combined with a bronze/steel coupling gear develop an impressive cutting power. Zero702 is able to cut any kind of material at the "soft" stage up to a maximum thickness of 18mm. This is why this model is widely applied in textile, technical fabrics or composite material fields. The high torque allows to cut even rubber materials and plastic base materials in the fields of carpets or floorings. The speed of the knife is adjustable electronically from 600 RPM to 1000 RPM in order to be suitable to cut any kind of material. The foot is steel made, strong and miniaturized so to allow to trim straight or curved portions very easily and precisely. The push button sharpening stone allows the sharpening of the knife edge to be done in less than 10 seconds without removing the knife. The new rear fixed knife protection is now transparent plastic made to give more visibility during the cut operations. The battery of latest generation is lithium ions technology so to be able to develop 5 Ah. It has an extraordinary life and it is possible to see the charging rate through a LED lamp. Through the standard charger the battery can be re-charged in 55 minutes while through the fast charger (option) battery can be re-charged in 30 minutes only. All these features make ZERO702 the battery hand-held cutting tool more revolutionary and powerfull on the market able to satisfy any need in field of professional cutting tools.



SPECIFICATIONS

Blade diameter: 70 mm (2.75"), with hard metal counterblade
Blade descr.: 70SHSS, 4-edges, HSS steel
Blade speed: 600-1000 r.p.m., adjustable
Cutting ability: 18 mm (0.7")
Power: 18 V, 400 W
Battery: 18 V Li-Ion®, 5.0 Ah rechargeable with charge status indicator LED
Recharging time: 55 min. (with standard charger)
Weight (with battery): 1900 g
Total weight (with packaging): 4400 g
Minimum brightness for working operations: 200 LUX
Vibrations at start up: < 2.5 m/sec²
Temperature range: 0 – 55° C
Umidity range: 10 – 95% without condensate

SAFETY

Heigh-adjustable trasparent fore blade protection
 Fixed trasparent back blade protection
 Thermic protection inside the battery

ACCESSORIES

Special Feet F7053A
Grinders SW1086DIA, F7055TN
Batteries BAT18
Chargers CH01, CH02
Rail G30-04
Stopper S30-04

Trailers C30-04, C30-0401, C30-0402
Blocking Pins F5057
Butterfly Keys F5059
Gear Grease T107900, T107901
Metal Gloves GMT-REV

BLADES Ø 70 MM





**POWERFUL
LIGHT
EASY**

Electric hand shears



APPLICATIONS

TEXTILE
TECHNICAL TEXTILE

DS504
ELECTRIC HAND SHEARS



Check the product
on our website



SPECIFICATIONS

Blade diameter: 50 mm (1.96")
with hard metal counterblade
Blade descr.: 503EEXT, 6-edge
50 mm dia. (1.96") EXTRA steel
Blade speed: 1800 r.p.m.
Cutting ability: up to 9 mm (0.35")
Power: single phase – 90 W
Max. absorption: 1 A, with protection fuse
Net weight: 935 g, 2 lb (with power supply cord)
Total weight (with packing box): 1570 g
Electric cable length: 1.5 mt (extensible)
Minimum brightness for working operations: LUX 200
Vibrations at start up: < 2.5 m/sec 2
Temperature range: 0 – 55 C
Umidity range: 10 – 95% without condensate

DESCRIPTION

For over 40years within the market, the model DS504 is the smallest, most powerfull and professional elecrcial hand-held cutting machine Rasor have ever produced. The DS504 is the sixth upgrade in the DS series resulting in the 2019 model which reaches the highest level in technology and safety. It weighs only 950 grams and its ergonomic design combined with a 90Watt balanced and silenced motor make this model (DS504) a unique cutting tool essential in all fields. A Reinforced body and bronze/steel gear coupling create a high torque which allows the use of this electrical shear not only in textile field but also in technical fabrics or leather fields. Rpm are now 1900 for ultra fast cut. The maximun cutting thickness is 9mm and the new push button sharpening stone allows the sharpening of the knife edge to be done in less than 10 seconds without removing the knife. The new circuit board includes a glass fuse which can be easily replaced without disassembling the shear and the new strong and slim shaped foot allows to trim curve sections very easily. The new model DS504 is truly a novel concentration of power and lightness in the field of professional cutting tools.



SAFETY

Safety start/stop device system
Heigh-adjustable trasparent fore blade protection
1 A cut-off fuse
Double electric insulation

BLADES Ø 50 MM

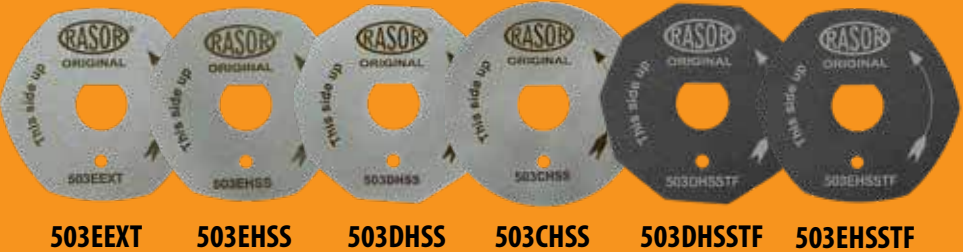

ACCESSORIES

Special Feet F5070A, F5070B
Rail G30-04
Stopper S30-04
Trailers C30-04, C30-0401, C30-0402
Blocking Pins F5057
Remote Handles RHA2
Butterfly Keys F5059
Gear Grease T107900, T107901
Metal Gloves GMT-REV

DS503MT

ELECTRIC HAND SHEARS

APPLICATIONS
TEXTILE
TECHNICAL TEXTILE

APPLICATIONS
TEXTILE
TECHNICAL TEXTILE
COMPOSITE

OPTIMA 703

ELECTRIC HAND SHEARS



Check the product
on our website



SPECIFICATIONS

Blade diameter: 50 mm (1.96"), with welded hard metal counterblade
Blade descr.: 50SEXTG, 7-edges, EXTRA steel
Blade speed: 1500 r.p.m.
Cutting ability: 9 mm (0.35")
Power: singlephase – 55 W
Max absorption: 1 A, with protection fuse
Net weight (with power supply cord): 950 g
Total weight (with packaging): 1570 g
Electric cable length: 1.5 mt (extensible)
Minimum brightness for working operations: 200 LUX
Vibrations at start up: < 2.5 m/sec 2
Temperature range: 0 – 55 C
Umidity range: 10 – 95% without condensate



DESCRIPTION

DS503MT is the new electrical hand-held cutting machine designed for trimming the edges. The new slim shaped foot is welded with a widia counterblade to reduce the overall dimension of the shear. With DS503MT is therefore possible to trim straight or curved sections of material with high precision. DS503MT is well used for trimming textile and leather in furnishing field (chairs, sofa and armchairs) while especially used to cut away the extra-waste material on moulds for plastic and glass fiber. It weighs only 950 grams and its ergonomic design combined with a 55Watt balanced and silenced motor make this model (DS503MT) a unique cutting tool very easy to be used. The maximum cutting thickness is 8mm and the new installed sharpening stone allows the sharpening of the knife edge to be done in less than 10 seconds without removing the knife. The new circuit board includes a glass fuse which can be easily replaced without disassembling the shear.

SAFETY

Safety start/stop device system
Fixed transparent fore blade protection
1 A cut-off fuse
Double electric insulation



ACCESSORIES

Special Feet F5053/S, F5053/
SCPL, P053/1CPL, P053/1SCPL
Blocking Pins F5057

Butterfly Keys F5059
Gear Grease T107900, T107901
Metal Gloves GMT-REV

BLADES Ø 50 MM



50SEXTG

50SGHSS

50CHSS

50CK

50SGHSSTF



Check the product
on our website



DESCRIPTION

This latest version in the OPTIMA series results a truly revolutionary hand-held cutting machine. Already over 2000 units sold of previous version the new 2019 model grant a highest level in technology ever reached before for a cutting tool of such a small size. Within small size and weight this model OPTIMA 703 reaches a power of 150 Watt which combined with a bonze and high resistance steel gear coupling allows an impressive cutting torque. RPM is now 1500 for ultra fast cut. OPTIMA 703 is able to cut any kind of soft material up to 18mm thickness. It is for this reason which is widely applied in textile, technical fabrics and composite material. The high torque allow to cut also rubber or plastic base material in the field of carpets and flooring. The motor housing is now PTFE coated for heat reducing with an aggressive "look". The steel foot being strong and of small dimension allows a very precise and easy cut of straight or curve sections. The push button sharpening stone allows the sharpening of the knife edge to be done in less than 10 seconds without removing the knife. The new circuit board includes a glass fuse which can be easily replaced without disassembling the shear and the new rare fixed protection is in transparent plastic to give better visibility during cutting operation. OPTIMA 703 is the cutting tool most revolutionary and powerfull on the market able to satisfy any kind of cutting professional demand.



BLADES Ø 70 MM



70SHSS

70EHSS

70CHSS

70DHSS

70DHSSTN

70DHSSTF

70EHSSTF

70SHSSTF

70EMD

SPECIFICATIONS

Blade diameter: 70 mm (2.75"), with hard metal counterblade
Blade descr.: 70SHSS, 4-edges, HSS steel
Blade Speed: 1500 r.p.m.
Cutting ability: 18 mm (0.7")
Power: monofase – 150 W
Max absorption: 1.25 A, with protection fuse
Net weight (with power supply cord): 1150 g
Total weight (with packaging): 2100 g
Electric cable length: 1.5 mt (estensibile)
Minimum brightness for working operations: 200 LUX
Vibrations at start up: < 2.5 m/sec 2
Temperature range: 0 – 55 C
Umidity range: 10 – 95% without condensate

SAFETY

Safety start/stop device system
Heigh-adjustable trasparent fore blade protection
Fixed trasparent back blade protection
1.25 A cut-off fuse
Double electric insulation

ACCESSORIES

Special Feet F5073A
Grinders SW1086DIA, F7055TN
Rail G30-04
Trailers C30-04, C30-0401,
C30-0402
Stopper S30-04

Blocking Pins F5057
Remote Handles RHA2
Butterfly Keys F5059
Gear Grease T107900, T107901
Metal Gloves GMT-REV



THE SOLUTION FOR NON STOP WORKING

Pneumatic hand shears

APPLICATIONS

TEXTILE

TECHNICAL TEXTILE

FP503

PNEUMATIC HAND SHEARS



Check the product
on our website



SPECIFICATIONS

Blade diameter: 50 mm (1.96"), with hard metal counterblade

Blade descr.: 503EEHSS, 6-edges, HSS steel

Blade speed: 1900 r.p.m.*

Cutting ability: 9 mm (0,35")

Power: 350 W (at nominal air supply conditions)*

Working pressure: 6 bar* (± 1 bar) with lubricated air

Air consumption: 9 l/sec*

Net weight: 800 g

Total weight (with packaging): 1630 g

Sound pressure: 72 dB (EN ISO 15744)*

Vibrations at start up: 1,36 m/sec² (ISO 8662)*

Minimum brightness for working operations: LUX 200

Temperature range: 0 – 55 C

Umidity range: 10 – 95% without condensate

* The reported data are collected at a pressure of 6 bar (ISO 2787: 1984), recommended operating pressure

DESCRIPTION

The newest model in FP series, FP503 is the lighter and most powerfull pneumatic hand-held cutting tool Rasor have ever produced in more than 70 years of work. The air motor is wholly made by Rasor. Thanks to latest generation pneumatic and mechanical components, the turbine reaches an extraordinary power of 350Watt in 22,000 RPM and a very high torque. The motor diameter is only 40mm that is the smallest within its cathegory. The rotor bldes are designed and produced in VANESTAR material so to reduce to minimun the weight and the friction. The cutting part has also been wholly reassessed : a reinforced structure and bronze/steel gear coupling create a high torque which allows the use of this pneumatic cutting tool not only in textile field but also in technical fabrics or leather fields. The max cutting thickness is now 9mm and the new push button sharpening stone allows the sharpening of the knife edge to be done in less than 10 seconds without removing the knife. The new stong and slim shaped foot allows to trim curved sections very easily. The new model FP503 is truly a novel concentration of power and lightness (it weights only 800 grams) in thefield of professional cutting tool.



Rasor reccomend to use only
dry air lubricated with special
Rasor VG 5 pneumatic oil

SAFETY

Double safety start-up system device

Heigh-adjustable trasparent fore blade protection

BLADES Ø 50 MM



503EEXT

503EHSS

503DHSS

503CHSS

503DHSSTF

503EHSSTF

ACCESSORIES

Special Feet F5070B, F5070A

Rail G30-04

Trailers C30-04, C30-0401, C30-0402

Stopper S30-04

Blocking Pins F5057

Butterfly Keys F5059

Gear Grease T107900, T107901

Metal Gloves GMT-REV

Fast Connectors P170, P171

Regulators P168

Tube P173

Silencers P029

Lubricants T107904, T107905

FP503MT

PNEUMATIC HAND SHEARS

APPLICATIONS
TEXTILE
TECHNICAL TEXTILE
COMPOSITE

APPLICATIONS
TEXTILE
TECHNICAL TEXTILE

FP702

PNEUMATIC HAND SHEARS



Check the product
on our website



SPECIFICATIONS

Blade diameter: 50 mm (1.96"), with welded hard metal counterblade
Blade descr.: 50SGHSS, 7-edges, HSS steel
Blade speed: 1900 r.p.m.*
Cutting ability: 9 mm (0.35")
Power: 350 W (at nominal air supply conditions)*
Working pressure: 6 bar* (±1 bar) with lubricated air
Air consumption: 9 l/sec*
Net weight: 780 g
Total weight (with packaging): 1600 g
Sound pressure: 72 dB (EN ISO 15744)*
Vibrations at start up: 1,36 m/sec² (ISO 8662)*
Minimum brightness for working operations: LUX 200
Temperature range: 0 – 55 C
Umidity range: 10 – 95% without condensate

*The reported data are collected at a pressure of 6 bar (ISO 2787: 1984), recommended operating pressure

SAFETY

Double safety start-up system device
 Fixed trasparent fore blade protection



DESCRIPTION

The new hand held cutting tool model FP503MT has been designed for the trimming edges cutting. The new foot has a slim shape with a welded carbide counterblade, that is to reduce the overall dimensions. This cutting tool is thus applied to trim with very high precision material having straight or curved edges. It is mainly used for trimming textile and leather within the furniture field and it is especially suitable for trimming away the over material in the molds for carbon fiber and glass fiber. The air compressed motor is wholly made by Rasor. Thanks to the latest generation mechanical and pneumatic components, the excellent turbine reaches a power of 350W at 22,000 RPM and a high torque. The motor diameter is now of only 40mm that is the smallest within its category. The rotor blades are made of VANESTAR® material which reduce to the minimum the weight and the friction. The maximum cutting thickness is of 9mm and the sharpening stone allows the sharpening of the knife edge to be done in less than 10 seconds without removing the knife. It is truly a novel concentration of power and lightness (it weighs only 780 grams) in the field of professional cutting tools.



Check the product
on our website



SPECIFICATIONS

Blade diameter: 70 mm (2.75"), with hard metal counterblade
Blade descr.: 70EHSS, 6-edges, HSS steel
Blade speed: 1300 r.p.m.*
Cutting ability: 18 mm (0.7")
Power: 380 W (at nominal air supply conditions)*
Working pressure: 6 bar* (±1 bar) with lubricated air
Air consumption: 9 l/sec*
Net weight: 920 g
Total weight (with packaging): 1750 g
Sound pressure: 72 dB (EN ISO 15744)*
Vibrations at start up: 1,36 m/sec² (ISO 8662)*
Minimum brightness for working operations: LUX 200
Temperature range: 0 – 55 C
Umidity range: 10 – 95% without condensate

*The reported data are collected at a pressure of 6 bar (ISO 2787: 1984), recommended operating pressure

SAFETY

Double safety start-up system device
 Height-adjustable transparent fore blade protection
 Fixed transparent back blade protection

DESCRIPTION

The new model FP702 is the best compromise between weight and power in the field of professional pneumatic hand-held cutting tools. The air motor is wholly made by Rasor. The new turbine has now 5 blades that assure higher power and torque reaching 380W in 16,000 RPM/turbine. The motor diameter is 40mm only, the smallest one in its range. The rotor blades are made of patented VANESTAR® material that minimize weight and friction. The new coupling gear in bronze and steel now reach 1300 RPM/knife to cut faster. On this new model the motor housing is PTFE coated to reduce more the heating on the cutting assembly. FP702 is able to cut any kind of material at the flexible state up to maximum cutting thickness of 18mm. This is the reason why this model is normally applied in textile, technical fabric and composite material field. The high torque allows to cut even rubber materials and plastics in carpet and flooring application. The base foot is steel made, strong and small size so to allow a easy and precise cut of straight or curved sections. The push button sharpener allows the sharpening of the knife edge to be done in less than 10 seconds without removing the knife. The fixed rear knife protection case is transparent plastic made to have more visibility during the cutting operations. FP702 is the best solution able to satisfy any need in the field of professional cutting tool weighing 920 grams only.



Rasor recommend to use only
dry air lubricated with special
Rasor VG 5 pneumatic oil

ACCESSORIES

Special Feet F5053/S, F5053/
SCPL, P053/1CPL, P053/1SCPL
Blocking Pins F5057
Butterfly Keys F5059
Gear Grease T107900, T107901
Metal Gloves GMT-REV

Fast Connectors P170, P171
Regulators P168
Tube P173
Silencers P029
Lubricants T107904, T107905

BLADES Ø 50 MM



50SEXTG

50SGHSS

50CHSS

50CK

50SGHSSTF

BLADES Ø 70 MM



70SHSS

70EHSS

70CHSS

70DHSS

70DHSSTN

70DHSSTF

70EHSSTF

70SHSSTF

70EMD

ACCESSORIES

Special Feet F7053A
Grinders SW1086DIA, F7055STN
Rail G30-04
Trailers C30-04, C30-0401,
C30-0402
Stopper S30-04
Blocking Pins F5057
Butterfly Keys F5059

Gear Grease T107900, T107901
Metal Gloves GMT-REV
Fast Connectors P170, P171
Regulators P168
Tube P173
Silencers P029
Lubricants T107904, T107905

FP862

PNEUMATIC HAND SHEARS

APPLICATIONS
TEXTILE
TECHNICAL TEXTILE
COMPOSITE

APPLICATIONS
COMPOSITE

FP862MT

PNEUMATIC HAND SHEARS



Check the product
on our website



SPECIFICATIONS

Blade diameter: 86 mm (3.4"), with hard metal counterblade
Blade descr.: 86THSS, 8-edges, HSS steel
Blade speed: 1400 r.p.m.*
Cutting ability: 25 mm (1")
Power: 400 W (at nominal air supply conditions)*
Working pressure: 6 bar* (±1 bar) with lubricated air
Air consumption: 9 l/sec*
Net weight: 1100 g
Total weight (with packaging): 1995 g
Sound pressure: 72 dB (EN ISO 15744)*
Vibrations at start up: 1,36 m/sec² (ISO 8662)*
Minimum brightness for working operations: LUX 200
Temperature range: 0 – 55 C
Umidity range: 10 – 95% without condensate

* The reported data are collected at a pressure of 6 bar (ISO 2787: 1984), recommended operating pressure

SAFETY

Double safety start-up system device
Heigh-adjustable trasparent fore blade protection
Fixed trasparent back blade protection



Rasor reccomend to use only
dry air lubricated with special
Rasor VG 5 pneumatic oil



ACCESSORIES

Grinders SW1086DIA,
SW1081TN
Rail G30-04
Trailers C30-04, C30-0401,
C30-0402
Stopper S30-04
Blocking Pins T107600
Butterfly Keys T107500

Gear Grease T107900, T107901
Metal Gloves GMT-REV
Fast Connectors P170, P171
Regulators P168
Tube P173
Silencers P029
Lubricants T107904, T107905

BLADES Ø 86 MM



86THSS

86PHSS

86THSSTN

86PHSSTF

86THSSTF

86TMD



Check the product
on our website



SPECIFICATIONS

Blade diameter: 86 mm (3.4"), with hard metal counterblade
Blade descr.: 86THSS, 8-edges, HSS steel
Blade speed: 1400 r.p.m.*
Cutting ability: 25 mm (1")
Power: 400 W (at nominal air supply conditions)*
Working pressure: 6 bar* (±1 bar) with lubricated air
Air consumption: 9 l/sec*
Net weight: 1100 g
Total weight (with packaging): 1995 g
Sound pressure: 72 dB (EN ISO 15744)*
Vibrations at start up: 1,36 m/sec² (ISO 8662)*
Minimum brightness for working operations: LUX 200
Temperature range: 0 – 55 C
Umidity range: 10 – 95% without condensate

* The reported data are collected at a pressure of 6 bar (ISO 2787: 1984), recommended operating pressure

DESCRIPTION

This hand held cutting tool is already become the most appreciated composite cutting tool all over the world. The new FP862MT cuts easily glass fiber, carbon fiber and kevlar up to a cutting thickness of 25mm. It weights only 1100 grams and the particular geometry between the knife and carbide counterblade combined with an innovative shape of the foot allow the cut of composite material with an extraordinary speed and precision. Especially the shape of the front peak allows the application of this cutting tool for edge trimming i.e. mould trimming. Furthermore, these particular building geometry avoid totally the trouble on winding for composite material such as the winding of the fiber behind the knife. Air compressed motor is wholly made by Rasor. thanks to the latest generation mechanical and pneumatic components, this excellent turbine reaches a power of 400W with 20,000 RPM and a very high torque. The diameter of motor is now of 40mm only, the smallest within its category. The rotor blade are made of VANESTAR® material which reduce to the minimun the weight and the friction. The motor housing is now PTFE coated for heat reducing with an aggressive "look". RPM is now 1400 for ultra fast cut. The push button sharpening stone allows the sharpening of the knife edge to be done in less than 10 seconds without removing the knife. The new fixed rear protection is now transparent plastic made to have more visibility during the cutting operations. Nowadays most of the producers/end users of composite material use normally model FP862MT for their cutting operations. Automotive, Shipbuilding and Aerospace Industry are the fields where this model FP862MT is mainly applied.



Rasor reccomend to use only
dry air lubricated with special
Rasor VG 5 pneumatic oil

ACCESSORIES

Grinders SW1086DIA,
Blocking Pins T107600
Butterfly Keys T107500
Gear Grease T107900, T107901
Metal Gloves GMT-REV

Fast Connectors P170, P171
Regulators P168
Tube P173
Silencers P029
Lubricants T107904, T107905

BLADES Ø 86 MM



86THSS

86PHSS

86THSSTN

86PHSSTF

86THSSTF

86TMD

FP861RC

PNEUMATIC HAND SHEARS

APPLICATIONS
TEXTILE

Check the product
on our website



SPECIFICATIONS

Blade diameter: 86 mm (3.4")
Blade descr.: 86THSSTF, 8-edges, HSS steel Teflon® coated
Blade speed: 900 r.p.m.*
Cutting ability: 3-10-20 mm (0.1-0.4-0.8"), with selector knob
Power: 400 W (at nominal air supply conditions)*
Working pressure: 6 bar* (±1 bar) with lubricated air
Air consumption: 9 l/sec*
Net weight: 1600 g
Total weight (with packaging): 3300 g
Sound pressure: 72 dB (EN ISO 15744)*
Vibrations at start up: 1,36 m/sec2 (ISO 8662)*
Minimum brightness for working operations: LUX 200
Temperature range: 0 – 55 C
Umidity range: 10 – 95% without condensate

* The reported data are collected at a pressure of 6 bar (ISO 2787: 1984), recommended operating pressure

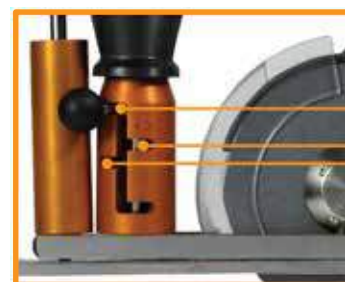

20 mm
10 mm
3 mm



DESCRIPTION

The pneumatic hand-held model FP861RC is definitely the most innovative and clever cutting tool. It allows the cut of material from the top (etching operation) by a 8-edges knife that comes out from the structure of the machine through the only pressure of the user. The model FP861RC is suitable mainly for cutting material in rolls shape like paper, fabric or recycle material. Beside, it can be used to cut flooring to be removed or disposed. The cutting operation of FP861RC is not through removing material but etching the material. A selector allows to adjust the outcoming knife in three positions: cutting thickness of 3mm, 10mm or 20mm. This model FP861RC is suitable to shear the paper rolls whenever it is necessary to cut in depth (20mm) and smaller cut (10mm or 3mm) to save the inside core (i.e. the carton roll). Model FP861MT replaces the use of standard blades and knives while increase the speed and quality of cut and the safety of the operators. Air compressed motor is wholly made by Rasor. thanks to the latest generation mechanical and pneumatic components, this excellent turbine reaches a power of 400W with 20,000 RPM and a very high torque. The diameter of motor is now of 40mm only, the smallest within its category. The rotor blade are made of VANESTAR® material which reduce to the minimum the weight and the friction. The push button sharpening stone allows the sharpening of the knife edge to be done in less than 10 seconds without removing the knife. The installed knife is 86mm diameter and teflon coated in order to go smoothly through the material and to reduce the friction between the knife and cutting material.

SAFETY

Double safety start-up system device
 Height-adjustable transparent fore blade protection
 Fixed transparent back blade protection
 Blade 100% covered on position "0"



Rasor recommend to use only
dry air lubricated with special
Rasor VG 5 pneumatic oil



ACCESSORIES

Grinders SW1086DIA,
 Blocking Pins T107600
 Butterfly Keys T107500
 Gear Grease T107900, T107901
 Metal Gloves GMT-REV

Fast Connectors P170, P171
 Regulators P168
 Tube P173
 Silencers P029
 Lubricants T107904, T107905

BLADES Ø 86 MM



86THSS

86PHSS

86PHSSTF

86THSSTF

86THSSTN

86TMD

RELIABLE & PROFESSIONAL

Electric bench cutters



APPLICATIONS

TEXTILE



Check the product
on our website

D86

ELECTRIC BENCH CUTTERS



SPECIFICATIONS

Blade diameter: 86 mm (3.4")
Blade descr.: 86CHSS, circular, HSS steel
Blade speed: 1000 r.p.m.
Cutting ability: 25 mm (1")
Power: singlephase – 90 W
Max absorption: 2 A, with protection fuse
Net weight (with power supply cord): 2900 g
Total weight (with packaging): 3900 g
Electric cable length: 1.5 mt (with no plug)
Minimum brightness for working operations: 200 LUX
Vibrations at start up: < 2.5 m/sec 2
Temperature range: 0 – 55 C
Umidity range: 10 – 95% without condensate

DESCRIPTION

D86 is the smallest model of bench cutting machine operating with a round knife. Model D86 is a powerfull and easy-handling cutteing machine which weighs less than 3 kilos. I founds large application in textile field and especially suitable to cut natural fiber as cotton, wool or silk. The semiautomatic stone sharpening system which can be operated by a proper lever allows the sharpening of the knife edge to be done in less than 10 seconds without removing the knife. Its aluminium base with rolls is Teflon® coated to be friction proof and to grant an easy feed with no efforts. The few maintenance and low operation cost make this model the best cutting machine for any application in textile field.



SAFETY

Double safety start-up system device
Main power switch with Led indicator
Heigh-adjustable trasparent fore blade protection
Fixed trasparent back blade protection
2 A cut-off fuse
Double electric insulation

BLADES Ø 86 MM



86CHSS

ACCESSORIES

Blocking Pins T107600
Butterfly Keys T107500
Trailers C30-0302, C30-0301
Stopper S30-03

Rail G30-03
Gear Grease T107900, T107901
Metal Gloves GMT-REV

D100

ELECTRIC BENCH CUTTERS

APPLICATIONS
TEXTILE



Check the product
on our website



SPECIFICATIONS

Blade diameter: 100 mm (4")
Blade descr.: 10CEXTG, circular, EXTRA steel
Blade speed: 1000 r.p.m.
Cutting ability: 35 mm (1.4")
Power: singlephase – 90 W
Max absorption: 2 A, with protection fuse
Net weight (with power supply cord): 2950 g
Total weight (with packaging): 4650 g
Electric cable length: 1.5 mt (with no plug)
Minimum brightness for working operations: 200 LUX
Vibrations at start up: < 2.5 m/sec 2
Temperature range: 0 – 55 C
Umidity range: 10 – 95% without condensate

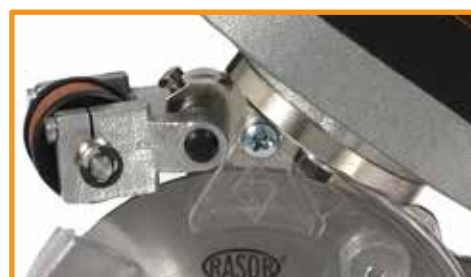

DESCRIPTION

For over 47 years within the market, the model D100 is the most efficient and popular bench cutting machine in textile application. It weighs less than 3 kilos and reached the highest level in technology and safety resulting a powerfull and easy-handling cutting machine. It finds Wide application in textile field. It is especially suitable to cut natural fiber as cotton, wool or silk. The semiatuomatic sharpening stone system to be operated by a proper lever allows the sharpening of the knife edge to be done in less than 10 seconds without removing the knife. The aluminium base with rolls is Teflon® coated to be friction proof and to grant an easy feed with no efforts. The low maintenance and low operation cost make surely this model (D100) the best cutting machine for any application in textile field



ACCESSORIES

Blocking Pins T107600
Butterfly Keys T107500
Trailers C30-0302, C30-0301
Stopper S30-03

Rail G30-03
Gear Grease T107900, T107901
Metal Gloves GMT-REV

BLADES Ø 100 MM



10CEXTG

10CGHSS

APPLICATIONS
TEXTILE
TECHNICAL TEXTILE



Check the product
on our website



D86P2

ELECTRIC BENCH CUTTERS



DESCRIPTION

D86P2 is the smallest model in Rasor range of bench cutting machine with a widia counterblade. It is a powerfull and easy-handling cutting machine which weigh less than 3 kilos. The 5-edge knife assure a sharp and precise cut without rag grinding. The diameter of the knife being only 86 mm allows an ease curve trimming and thin sections. The semiautomatic stone sharpening system allows the sharpening of the knife edge to be done in only 10 seconds without removing the knife. The aluminium base with rolls is Teflon® coated to be friction proof and to grant an easy feed with no efforts. D86P2 is widely applied in textile, technical fabrics and in the leather and carpets industries. The few maintenance and low operation cost make D86P2 to be the best cutting solution for any of your application.



BLADES Ø 86 MM



86THSS

86PHSS

86THSSTN

86PHSSTF

86THSSTF

86TMD

SPECIFICATIONS

Blade diameter: 86 mm (3.4"), with hard metal counterblade
Blade descr.: 86PHSS, 5-edges, HSS steel
Blade speed: 850 r.p.m.
Cutting ability: 25 mm (1")
Power: singlephase – 90 W
Max absorption: 2 A, with protection fuse
Net weight (with power supply cord): 2900 g
Total weight (with packaging): 4600 g
Electric cable length: 1.5 mt (with no plug)
Minimum brightness for working operations: 200 LUX
Vibrations at start up: < 2.5 m/sec 2
Temperature range: 0 – 55 C
Umidity range: 10 – 95% without condensate

SAFETY

Double safety start-up system device
 Main power switch with Led indicator
 Heigh-adjustable trasparent fore blade protection
 Fixed trasparent back blade protection
 2 A cut-off fuse
 Double electric insulation

ACCESSORIES

Grinders SW1086DIA, SW1081TN
Blocking Pins T107600
Butterfly Keys T107500
Trailers C30-0302, C30-0301

Stopper S30-03
Rail G30-03
Gear Grease T107900, T107901
Metal Gloves GMT-REV

SW100

ELECTRIC BENCH CUTTERS

APPLICATIONS
TEXTILE
TECHNICAL TEXTILE



Check the product
on our website



Check the product
on our website

SPECIFICATIONS

Blade diameter: 100 mm (4"), with hard metal counterblade
Blade descr.: 10EHSS, 6-edges, HSS steel
Blade speed: 850 r.p.m.
Cutting ability: 35 mm (1.4")
Power: singlephase – 90 W
Max absorption: 2 A, with protection fuse
Net weight (with power supply cord): 2950 g
Total weight (with packaging): 4650 g
Electric cable length: 1.5 mt (with no plug)
Minimum brightness for working operations: 200 LUX
Vibrations at start up: < 2.5 m/sec 2
Temperature range: 0 – 55 C
Umidity range: 10 – 95% without condensate



DESCRIPTION

For over 30 years within the market, SW100 is the most efficient and popular bench cutting machine in textile and technical fabrics fields. It reached the highest level of technology and safety and can grant power and easy handling due to its weigh of only 3 kilos. The combination bbltween blade and counterblade make the cut to be sharp and precise without any rag grinding. The 90Watt balanced and silenced motor combined with high resistance bronze/steel gear couplings create a long lasting stability. The 6-edge 100mm diameter knife allows to cut any kind of fabric up to 35mm thickness. The aluminium cutter base with rolls is Teflon® coated to be friction proof and grant an easy feed of the fabric with no efforts. The push button sharpening stone allow the sharpening of the knife edge to be done in less than 10 seconds without removing the knife. The low maintenance and low operation cost make surely SW100 to be the best cutting machine suitable for any application in textile and technical fabrics fields.



SAFETY

Double safety start-up system device
Main power switch with Led indicator
Heigh-adjustable trasparent fore blade protection
Fixed trasparent back blade protection
2 A cut-off fuse
Double electric insulation

ACCESSORIES

Grinders SW1086DIA,
SW1081TN
Blocking Pins T107600
Butterfly Keys T107500
Trailers C30-0302, C30-0301

Stopper S30-03
Rail G30-03
Gear Grease T107900, T107901
Metal Gloves GMT-REV

BLADES Ø 100 MM



APPLICATIONS
TEXTILE
TECHNICAL TEXTILE

SW12

ELECTRIC BENCH CUTTERS



DESCRIPTION

SW12 is the biggest Rasor bench cutting machine. For over 30 years within the market, the model SW12 reached the highest level in technology and safety and still can collect a big success in the high thickness cutting application. Its 120mm diameter knife allows the cut of fabrics upto 50mm thickness. The powerfull 180Watt motor combined with a strong bronze/steel coupling gears create high torque plus a high blade speed of 850rpm. SW12 is widely applied in textile or technical fabrics fields and it is especially suitable to cut high thickness material like mattress, foams and natural fibers in many layers. The new push button sharpening stone allows the sharpening of the knife edge to be done in less than 10 seconds without removing the knife. The aluminium cutting base with rolls is Teflon® coated to allow the easy feed of the machine and the reduction of the friction between the platform and the material. Model SW12 is definetly the best professional bench cutting machine for high thickness.



SPECIFICATIONS

Blade diameter: 120 mm (4.7"), with hard metal counter-blade
Blade descr.: 12SHSS, 8-edges, HSS steel
Blade speed: 850 r.p.m.
Cutting ability: 50 mm (2")
Power: singlephase – 180 W
Max absorption: 2.5 A, with protection fuse
Net weight (with power supply cord): 4500 g
Total weight (with packaging): 6200 g
Electric cable length: 1.5 mt (with no plug)
Minimum brightness for working operations: 200 LUX
Vibrations at start up: < 2.5 m/sec 2
Temperature range: 0 – 55 C
Umidity range: 10 – 95% without condensate

SAFETY

Double safety start-up system device
Main power switch with Led indicator
Heigh-adjustable trasparent fore blade protection
Fixed trasparent back blade protection
2.5 A cut-off fuse
Double electric insulation

ACCESSORIES

Grinders SW1286DIA,
SW1081TN
Blocking Pins T107600
Butterfly Keys T107500
Trailers C30-0302, C30-0301

Stopper S30-03
Rail G30-03
Gear Grease T107900, T107901
Metal Gloves GMT-REV

BLADES Ø 120 MM



SW12M

ELECTRIC BENCH CUTTERS

APPLICATIONS
TECHNICAL TEXTILE
COMPOSITE

MONSTER



Check the product
on our website



SPECIFICATIONS

Blade diameter: 120 mm (4.7"), with hard metal counterblade
Blade descr.: 12SHSS, 8-edges, HSS steel
Blade speed: 550 r.p.m.
Cutting ability: 50 mm (2")
Power: singlephase – 350 W
Max absorption: 2.5 A, with protection fuse
Net weight (with power supply cord): 4500 g
Total weight (with packaging): 6200 g
Electric cable length: 1.5 mt (with no plug)
Minimum brightness for working operations: 200 LUX
Vibrations at start up: < 2.5 m/sec 2
Temperature range: 0 – 55 C
Umidity range: 10 – 95% without condensate



DESCRIPTION

SW12M is Rasor new generation bench cutting machine. Launched on the market only few years ago SW12M gives its excellency to the new geometry of the motor housing of Monster series. The difference between SW12M and the other Rasor bench cutting machine is given by its motor housing held by a central foot fitted behind the blade in central position. This system spreads the shearing stress and the necessary stress to move the machine through the fabrics on both sides of the cutter and cut is so done perfectly straight and smooth. The knife is half-free on both sides to avoid winding problems even with tough fibers. SW12M is especially suitable to cut composite materials like glass fiber, carbon fiber, kevlar or any soft material up to 50mm thickness. The impressive 350Watt motor combined with a bronze/steel coupling gear create a very high torque which combined with the slow RPM of the knife allow to cut even rubber materials and plastic based material in the field of carpets and industrial flooring. The push button sharpening stone allows the sharpening of the knife edge to be done in less than 10 seconds without removing the knife. SW12M... just over the limits.

SAFETY

Double safety start-up system device
Main power switch with Led indicator
Height-adjustable transparent fore blade protection
Fixed transparent back blade protection
2.5 A cut-off fuse
Double electric insulation



ACCESSORIES

Grinders SW1286DIA,
SW1081TN
Blocking Pins T107600
Butterfly Keys T107500
Trailers C30-0302, C30-0301

Stopper S30-03
Rail G30-03
Gear Grease T107900, T107901
Metal Gloves GMT-REV

BLADES Ø 120 MM



12SHSS

12CHSS

12SHSSTN

12SHSSTF

12SMD

POWER & PRODUCTION EFFICIENCY

Pneumatic cutting units

APPLICATIONS

TEXTILE
TECHNICAL TEXTILE

FP861V2
PNEUMATIC CUTTING UNITS



Check the product
on our website



SPECIFICATIONS

Blade diameter: 86 mm (3.4"), with hard metal counterblade
Blade descr.: 86THSS, 8-edges, HSS steel
Blade speed: 900 r.p.m.*
Cutting ability: 25 mm (1")
Power: 400 W (at nominal air supply conditions)*
Working pressure: 6 bar* (±1 bar) with lubricated air
Air consumption: 9 l/sec*
Net weight: 1300 g
Total weight (with packaging): 3000 g
Sound pressure: 72 dB (EN ISO 15744)*
Vibrations at start up: 1,36 m/sec2 (ISO 8662)*
Minimum brightness for working operations: LUX 200
Temperature range: 0 – 55 C
Umidity range: 10 – 95% without condensate

* The reported data are collected at a pressure of 6 bar (ISO 2787: 1984), recommended operating pressure

SAFETY

Heigh-adjustable trasparent fore blade protection
Fixed trasparent back blade protection

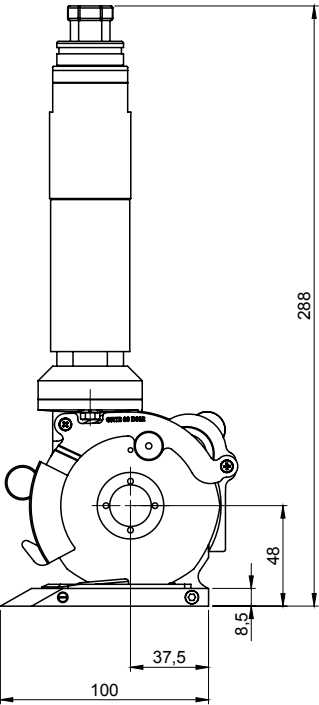

DESCRIPTION

Model FP861V2 is a pneumatic cutting unit to cut textile and technical fabrics. The air compressed motor is wholly made by Rasor. Thanks to the latest generation mechanical and pneumatic components, the excellent turbine reaches a power of 400W at 20,000 RPM and a high torque. The motor diameter is now of 40mm only that is the smallest within its category. The rotor blades are made of VANESTAR® material which reduce to the minimum the weight and the friction. The installed knife of 86mm diameter 8-edges allow the cutting of any kind of material at the "flexible stage" up to a cutting thickness of 25mm. The high torque and the slow speed of the knife allow the cutting of rubber material with plastic base in the carpet and light flooring application. Especially suitable for transversal cutting the model FP861V2 is also suitable to be installed in small spaces thanks to the vertical position of the motor. This model is arranged with an anchor flange easy to be fitted on fixed or automatic stirrup. The base is Teflon® coated and allows the easy movement of the cutting tool reducing the friction between the base and the cutting material. It can be installed on sliding rails within a small space. The new semi-automatic push button sharpening stone allows the sharpening of the knife edge to be done in less than 10 seconds without removing the knife. The small maintenance and small handling costs make the model FP861V2 the best solution for a powerful and reliable cutting within any O.E.M. application.



 *Rasor recommend to use only dry air lubricated with special Rasor VG 5 pneumatic oil*

BLADES Ø 86 MM



86THSS 86PHSS 86THSSTN 86PHSSTF 86THSSTF 86TMD

ACCESSORIES

Grinders SW1086DIA, SW1081TN
Blocking Pins T107600
Butterfly Keys T107500
Trailers C30-03, C30-0302, C30-0301
Stopper S30-03
Rail G30-03
Gear Grease T107900, T107901
Metal Gloves GMT-REV
Fast Connectors P170, P171
Regulators P168
Tube P173
Silencers P029
Lubricants T107904, T107905

FP861A2

PNEUMATIC CUTTING UNITS

SPECIFICATIONS

Blade diameter: 86 mm (3.4"), with hard metal counterblade
Blade descr.: 86THSS, 8-edges, HSS steel
Blade speed: 900 r.p.m.*
Cutting ability: 25 mm (1")
Power: 400 W (at nominal air supply conditions)*
Working pressure: 6 bar* (± 1 bar) with lubricated air
Air consumption: 9 l/sec*
Net weight: 1350 g
Total weight (with packaging): 3050 g
Sound pressure: 72 dB (EN ISO 15744)*
Vibrations at start up: 1,36 m/sec² (ISO 8662)*
Minimum brightness for working operations: LUX 200
Temperature range: 0 – 55 C
Umidity range: 10 – 95% without condensate

* The reported data are collected at a pressure of 6 bar (ISO 2787: 1984), recommended operating pressure

SAFETY

Heigh-adjustable trasparent fore blade protection
 Fixed trasparent back blade protection



Check the product
on our website

DESCRIPTION

Model FP861A2 is a pneumatic cutting unit to cut textile and technical fabrics. The air compressed motor is wholly made by Rasor. Thanks to the latest generation mechanical and pneumatic components, the excellent turbine reaches a power of 400W at 20,000 RPM and a high torque. The motor diameter is now of 40mm only that is the smallest within its cathegory. The rotor blades are made of VANESTAR® material which reduce to the minimun the weighth and he friction. The installed knife of 86mm diameter 8-edges allow the cutting of any kind of material at the "flexible stage" up to a cutting thickness of 25mm. The high torque and the slow speed of the knife allow the cutting of rubber material with plastic base in the carpet and light flooring application. Especially suitable for transversal cutting model FP861A2 is suitable to be installed in small spaces thanks to the vertical position of the motor. This model is arranged with an anchor flange easy to be fitted on fixed or automatic stirrup. The new mini Teflon® coated base allows the easy movement of the cutting tool which can also be installed on sliding rails within a small space. The new semi-automatic push button sharpening stone allows the sharpening of the knife edge to be done in less than 10 seconds without removing the knife. The small maintenance and small handling costs make the model FP861A2 the best solution for a powerfull and reliable cutting within any O.E.M. application.

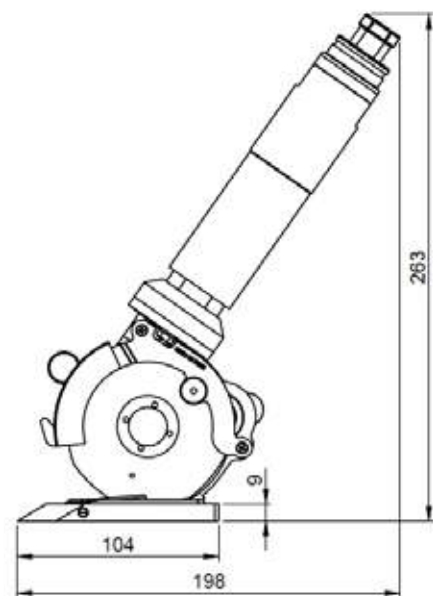

Rasor reccomend to use only
dry air lubricated with special
Rasor VG 5 pneumatic oil



ACCESSORIES

Grinders SW1081TN
Blocking Pins T107600
Butterfly Keys T107500
Trailers C30-03, C30-0302,
 C30-0301
Stopper S30-03
Rail G30-03

Gear Grease T107900, T107901
Metal Gloves GMT-REV
Fast Connectors P170, P171
Regulators P168
Tube P173
Silencers P029
Lubricants T107904, T107905

BLADES Ø 86 MM



FP100

PNEUMATIC CUTTING UNITS



Check the product
on our website



SPECIFICATIONS

Blade diameter: 100 mm (4"), with hard metal counterblade
Blade descr.: 10EHSS, 6-edges, HSS steel
Blade speed: 900 r.p.m.*
Cutting ability: 35 mm (1.4")
Power: 400 W (at nominal air supply conditions)*
Working pressure: 6 bar* (± 1 bar) with lubricated air
Air consumption: 9 l/sec*
Net weight: 1350 g
Total weight (with packaging): 3050 g
Sound pressure: 72 dB (EN ISO 15744)*
Vibrations at start up: 1,36 m/sec² (ISO 8662)*
Minimum brightness for working operations: LUX 200
Temperature range: 0 – 55 C
Umidity range: 10 – 95% without condensate

* This model is also available in left side version (specular) as model **FP100L**

* The reported data are collected at a pressure of 6 bar (ISO 2787: 1984), recommended operating pressure

SAFETY

Heigh-adjustable trasparent fore blade protection
 Fixed trasparent back blade protection

DESCRIPTION

Model FP100 is a pneumatic cutting unit for the cutting of textile and technical fabrics. The air compressed motor is wholly made by Rasor. Thanks to the latest generation mechanical and pneumatic components, the excellent turbine reaches a power of 400W at 20,000 RPM and a high torque. The motor diameter is now of 40mm only that is the smallest within its cathegory. The rotor blades are made of VANESTAR® material which reduce to the minimum the weighth and the friction. The installed knife of 100mm diameter 6-edges allow the cutting of any kind of material at the "flexible stage" up to a cutting thickness of 35mm. The high torque and the slow speed of the knife allow the cutting of rubber material with plastic base in the carpet and light flooring application. Especially suitable for transversal cutting model FP100 is suitable to be installed in small spaces thanks to the vertical position of the motor. This model is arranged with an anchor flange easy to be fitted on fixed or automatic stirrup. The Teflon® coated base allows the easy movement of the cutting tool which can also be installed on sliding rails within a small space. For continuous trimming process FP100 is also available as left hand side version (specular) as model FP100L. The semi-automatic push button sharpening stone allows the sharpening of the knife edge to be done in less than 10 seconds without removing the knife. The small maintenance and small handling costs make the model FP100 the best solution for a powerfull and reliable cutting within any O.E.M. application.

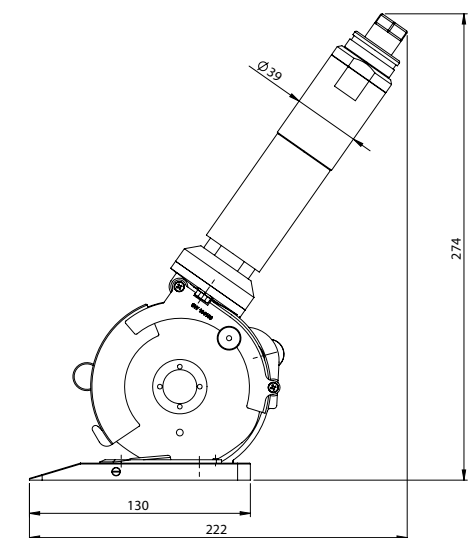

Rasor reccomend to use only
dry air lubricated with special
Rasor VG 5 pneumatic oil

BLADES Ø 100 MM



ACCESSORIES

Grinders SW1086DIA,
 SW1081TN
Blocking Pins T107600
Butterfly Keys T107500
Trailers C30-03, C30-0302,
 C30-0301
Stopper S30-03
Rail G30-03

Gear Grease T107900, T107901
Metal Gloves GMT-REV
Fast Connectors P170, P171
Regulators P168
Tube P173
Silencers P029
Lubricants T107904, T107905

FP100L

PNEUMATIC CUTTING UNITS

SPECIFICATIONS

Blade diameter: 100 mm (4"), with hard metal counterblade
Blade descr.: 10EHSS, 6-edges, HSS steel
Blade speed: 900 r.p.m.*
Cutting ability: 35 mm (1.4")
Power: 400 W (at nominal air supply conditions)*
Working pressure: 6 bar* (±1 bar) with lubricated air
Air consumption: 9 l/sec*
Net weight: 1350 g
Total weight (with packaging): 3050 g
Sound pressure: 72 dB (EN ISO 15744)*
Vibrations at start up: 1,36 m/sec² (ISO 8662)*
Minimum brightness for working operations: LUX 200
Temperature range: 0 – 55 C
Umidity range: 10 – 95% without condensate

* This model is also available in right side version (specular) as model **FP100**
 * The reported data are collected at a pressure of 6 bar (ISO 2787: 1984), recommended operating pressure

SAFETY

Heigh-adjustable trasparent fore blade protection
 Fixed trasparent back blade protection



DESCRIPTION

Model FP100L is a pneumatic cutting unit for the cutting of textile and technical fabrics. The air compressed motor is wholly made by Rasor. Thanks to the latest generation mechanical and pneumatic components, the excellent turbine reaches a power of 400W at 20,000 RPM and a high torque. The motor diameter is now of 40mm only that is the smallest within its category. The rotor blades are made of VANESTAR® material which reduce to the minimum the weighth and the friction. The installed knife of 100mm diameter 6-edges allow the cutting of any kind of material at the "flexible stage" up to a cutting thickness of 35mm. The high torque and the slow speed of the knife allow the cutting of rubber material with plastic base in the carpet and light flooring application. Especially suitable for transversal cutting model FP100L is suitable to be installed in small spaces thanks to the vertical position of the motor. This model is arranged with an anchor flange easy to be fitted on fixed or automatic stirrup. The Teflon® coated base allows the easy movement of the cutting tool which can also be installed on sliding rails within a small space. For continuous trimming process FP100L is also available as right hand side version (specular) as model FP100. The new semi-automatic push button sharpening stone allows the sharpening of the knife edge to be done in less than 10 seconds without removing the knife. The small maintenance and small handling costs make the model FP100L the best solution for a powerfull and reliable cutting within any O.E.M. application.

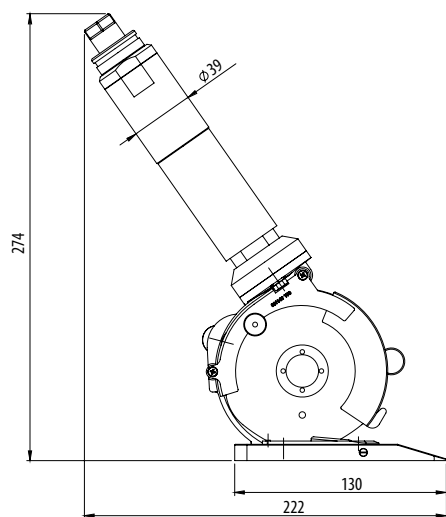

Rasor reccomend to use only dry air lubricated with special Rasor VG 5 pneumatic oil



ACCESSORIES

Grinders SW1086DIA, SW1081STN
Blocking Pins T107600
Butterfly Keys T107500
Trailers C30-03, C30-0302, C30-0301
Stopper S30-03
Rail G30-03

Gear Grease T107900, T107901
Metal Gloves GMT-REV
Fast Connectors P170, P171
Regulators P168
Tube P173
Silencers P029
Lubricants T107904, T107905

BLADES Ø 100 MM



10EHSS

10CSW

10SEXTG

10EHSSTF

10EMD

APPLICATIONS

TEXTILE

TECHNICAL TEXTILE

Check the product on our website



APPLICATIONS

TEXTILE

TECHNICAL TEXTILE

COMPOSITE



Check the product on our website

MONSTER

1HP power



SPECIFICATIONS

Blade diameter: 120 mm (4.7"), with hard metal counterblade
Blade descr.: 12SHSS, 8-edges, HSS steel
Blade speed: 550 r.p.m.*
Cutting ability: 50 mm (2")
Power: 800 W (at nominal air supply conditions)*
Working pressure: 6 bar* (±1 bar) with lubricated air
Air consumption: 18 l/sec*
Net weight: 4300 g
Total weight (with packaging): 6000 g
Sound pressure: 72 dB (EN ISO 15744)*
Vibrations at start up: 1,36 m/sec² (ISO 8662)*
Minimum brightness for working operations: LUX 200
Temperature range: 0 – 55 C
Umidity range: 10 – 95% without condensate

* This model is also available in left side version (specular) as model **FP120SM**
 * The reported data are collected at a pressure of 6 bar (ISO 2787: 1984), recommended operating pressure

SAFETY

Heigh-adjustable trasparent fore blade protection
 Fixed trasparent back blade protection

DESCRIPTION

Model FP120M is a pneumatic cutting unit for cutting textile, technical fabrics and composite material having high thickenss even with multi-layer. This is the most powerful cutting unit that Rasor have ever produced. The air compressed motor is wholly made by Rasor. Thanks to the latest generation mechanical and pneumatic components, the excellent turbine reaches a power of 800 W at 15.500 RPM and a very high torque. Recently developped this model gives its ecclency to the new geometry of the motor housing of Monster series. Differently from the other models of cutting units FP120M has the motor housing held by a central foot fitted behind the blade in central position. This system spreads the shearing stress and the necessary stress to move the machine through the fabrics on both sides of the cutter and cut is so done perfectly straight and smooth. The knife is half-free on both sides to avoid winding problems even with tough fibers. FP120M is especially suitable to cut composite materials like glass fiber, carbon fiber and kevlar. The installed knife of 120 mm diameter 8-edges allow the cutting of any kind of material at the "flexible stage" up to a cutting thickness of 50mm. The push button sharpening stone allows the sharpening of the knife edge to be done in less than 10 seconds without removing the knife. The high torque and the slow speed of the knife allow the cutting of rubber material with plastic base in the carpet and light flooring application. FP120M is especially suitable for the transversal cut and to be installed in small spaces and it is arranged with an anchor flange easy to be fitted on fixed or automatic stirrup. The Teflon® coated aluminium basse reduce the friction between the foot and the material and allow the easy forward movement even for an installation sliding rails. For the continuous trimming process FP120M is also available in left side version (specular) as model FP120SM. FP120M simply equal to top power and top performance for your O.E.M. application.

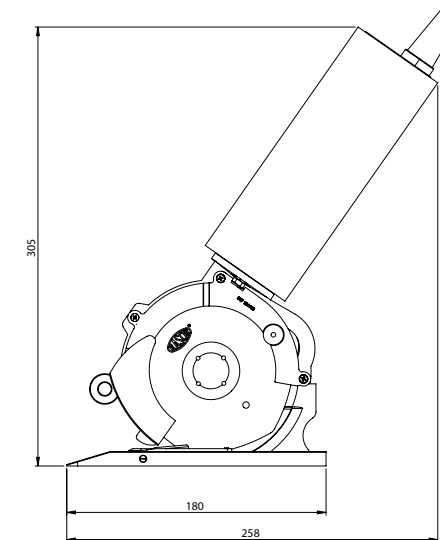

Rasor reccomend to use only dry air lubricated with special Rasor VG 5 pneumatic oil

BLADES Ø 120 MM



12SHSS

12CHSS

12SHSSTN

12SHSSTF

12SMD

ACCESSORIES

Grinders SW1286DIA, SW1081TN
Blocking Pins T107600
Butterfly Keys T107500
Trailers C30-03, C30-0302, C30-0301
Stopper S30-03

Rail G30-03
Gear Grease T107900, T107901
Metal Gloves GMT-REV
Fast Connectors P170, P171
Regulators P168
Tube P173
Lubricants T107904, T107905

FP120SM

PNEUMATIC CUTTING UNITS

SPECIFICATIONS

Blade diameter: 120 mm (4.7"), with hard metal counterblade
Blade descr.: 12SHSS, 8-edges, HSS steel
Blade speed: 550 r.p.m.*
Cutting ability: 50 mm (2")
Power: 800 W (at nominal air supply conditions)*
Working pressure: 6 bar* (±1 bar) with lubricated air
Air consumption: 18 l/sec*
Net weight: 4300 g
Total weight (with packaging): 6000 g
Sound pressure: 72 dB (EN ISO 15744)*
Vibrations at start up: 1,36 m/sec² (ISO 8662)*
Minimum brightness for working operations: LUX 200
Temperature range: 0 – 55 C
Umidity range: 10 – 95% without condensate

* This model is also available in right side version (specular) as model **FP120M**
 * The reported data are collected at a pressure of 6 bar (ISO 2787: 1984), recommended operating pressure

SAFETY

Heigh-adjustable trasparent fore blade protection
 Fixed trasparent back blade protection

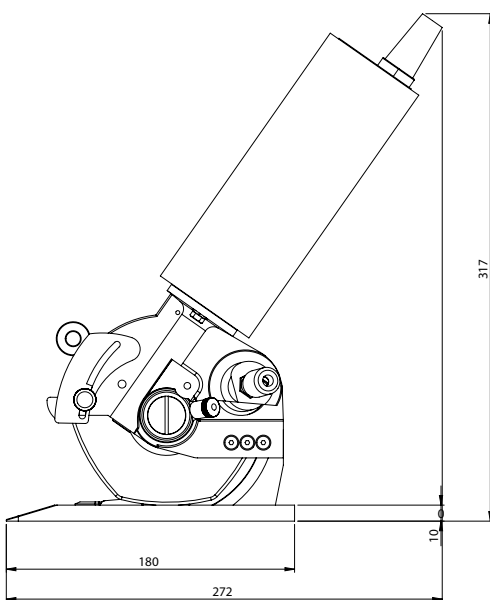

Rasor recommend to use only dry air lubricated with special Rasor VG 5 pneumatic oil



DESCRIPTION

Model FP120SM is a pneumatic cutting unit for cutting textile, technical fabrics and composite material having high thickness even with multi-layer. This is the most powerful cutting unit that Rasor have ever produced. The air compressed motor is wholly made by Rasor. Thanks to the latest generation mechanical and pneumatic components, the excellent turbine reaches a power of 800 W at 15.500 RPM and a very high torque. Recently developped this model gives its excellency to the new geometry of the motor housing of Monster series. Differently from the other models of cutting units FP120SM has the motor housing held by a central foot fitted behind the blade in central position. This system spreads the shearing stress and the necessary stress to move the machine through the fabrics on both sides of the cutter and cut is so done perfectly straight and smooth. The knife is half-free on both sides to avoid winding problems even with tough fibers. FP120SM is especially suitable to cut composite materials like glass fiber, carbon fiber and kevlar. The installed knife of 120 mm diameter 8-edges allow the cutting of any kind of material at the "flexible stage" up to a cutting thickness of 50mm. The push button sharpening stone allows the sharpening of the knife edge to be done in less than 10 seconds without removing the knife. The high torque and the slow speed of the knife allow the cutting of rubber material with plastic base in the carpet and light flooring application. FP120SM is especially suitable for the transversal cut and to be installed in small spaces and it is arranged with an anchor flange easy to be fitted on fixed or automatic stirrup. The Teflon® coated aluminium basse reduce the friction between the foot and the material and allow the easy forward movement even for an installation sliding rails. For the continuous trimming process FP120SM is also available in right version (specular) as model FP120M. FP120SM simply equal to top power and top performance for your O.E.M. application

BLADES Ø 120 MM



12SHSS

12CHSS

12SHSSTN

12SHSSTF

12SMD

ACCESSORIES

Grinders SW1286DIA, SW1081STN
 Blocking Pins T107600
 Butterfly Keys T107500
 Trailers C30-03, C30-0302, C30-0301
 Stopper S30-03

Rail G30-03
 Gear Grease T107900, T107901
 Metal Gloves GMT-REV
 Fast Connectors P170, P171
 Regulators P168
 Tube P173
 Lubricants T107904, T107905

APPLICATIONS
 TEXTILE
 TECHNICAL TEXTILE
 COMPOSITE

Check the product
 on our website



MONSTER
 1HP power



APPLICATIONS
 TEXTILE
 TECHNICAL TEXTILE
 COMPOSITE



Check the product
 on our website



DESCRIPTION

Model FP120DT is a pneumatic cutting unit for cutting textile, technical fabrics and composite material having high thickness even with multi-layer. Thanks to the double carbide counter-blade FP120DT is able to cut on both directions (through a double air inlet). This peculiarity allow to save a run and time during the cross-cut process. The air compressed motor is made of the latest generation mechanical and pneumatic components, the excellent turbine reaches a power of 645 W at 15,500 RPM and a very high torque. FP120DT has a 120mm 8-edges knife which allows to cut any kind of materiale at the "flexible stage" up to a cutting thickness of 50mm. The push button sharpening stone allows the sharpening of the knife edge to be done in less than 10 seconds without removing the knife. The high torque and the slow speed of the knife allow the cutting of rubber material with plastic base in the carpet and light flooring application. FP120DT is especially suitable for the transversal cut and to be installed in small spaces and it is arranged with an anchor flange easy to be fitted on fixed or automatic stirrup. The aluminium Teflon® coated base reduce the friction between the foot and the material and allow the easy forward movement even for an installation sliding rails. The power and bidirectional feature make FP120DT the best solution for the most difficult O.E.M. application.



SPECIFICATIONS

Blade diameter: 120 mm (4.7"), with double hard metal counterblade
Blade descr.: 12SHSS, 8-edges, HSS steel
Blade speed: 550 r.p.m.*
Cutting ability: 50 mm (2"), bidirectional
Power: 645 W (at nominal air supply conditions)*
Working pressure: 6 bar* (±1 bar) with lubricated air
Air consumption: 18 l/sec*
Net weight: 4350 g
Total weight (with packaging): 6050 g
Sound pressure: 72 dB (EN ISO 15744)*
Vibrations at start up: 1,36 m/sec² (ISO 8662)*
Minimum brightness for working operations: LUX 200
Temperature range: 0 – 55 C
Umidity range: 10 – 95% without condensate

* The reported data are collected at a pressure of 6 bar (ISO 2787: 1984), recommended operating pressure

SAFETY

Heigh-adjustable trasparent fore blade protection
 Fixed trasparent back blade protection

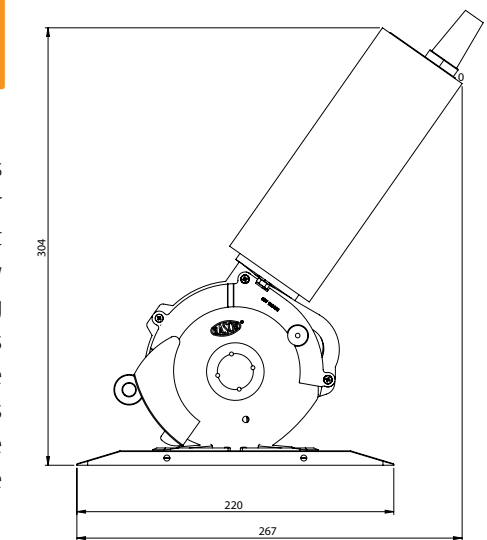

Rasor recommend to use only dry air lubricated with special Rasor VG 5 pneumatic oil

BLADES Ø 120 MM



12SHSS

12CHSS

12SHSSTN

12SHSSTF

12SMD

ACCESSORIES

Grinders SW1286DIA, SW1081TN, SW1081STN
 Blocking Pins T107600
 Butterfly Keys T107500
 Trailers C30-0302
 Stopper S30-03
 Rail G30-03

Gear Grease T107900, T107901
 Metal Gloves GMT-REV
 Fast Connectors P170, P171
 Regulators P168
 Tube P173
 Lubricants T107904, T107905

A close-up photograph of a blue and white woven fabric, possibly a textile or carpet. The fabric has a distinct diagonal rib pattern. Orange-colored threads are visible, forming a decorative border or stitching along the edge of the fabric. The lighting is soft, highlighting the texture of the fibers.

**SPEED &
PRECISION**

SinglePhase cutting units

APPLICATIONS
TEXTILE
TECHNICAL TEXTILE

D86PS2
SINGLEPHASE CUTTING UNITS



Check the product
on our website



SPECIFICATIONS

- Blade diameter: 86 mm (3.4"), with hard metal counterblade
- Blade descr.: 86PHSS, 5-edges, HSS steel
- Blade speed: 850 r.p.m.
- Cutting ability: 25 mm (1")
- Power: singlephase – 90 W
- Max absorption: 2 A
- Net weight (with power supply cord): 2500 g
- Total weight (with packaging): 4990 g
- Electric cable length: 1.5 mt (with no plug)
- Minimum brightness for working operations: 200 LUX
- Vibrations at start up: < 2.5 m/sec 2
- Temperature range: 0 – 55 C
- Umidity range: 10 – 95% without condensate

SAFETY

- Main power switch with Led indicator
- Heigh-adjustable trasparent fore blade protection
- Fixed trasparent back blade protection
- Double electric insulation

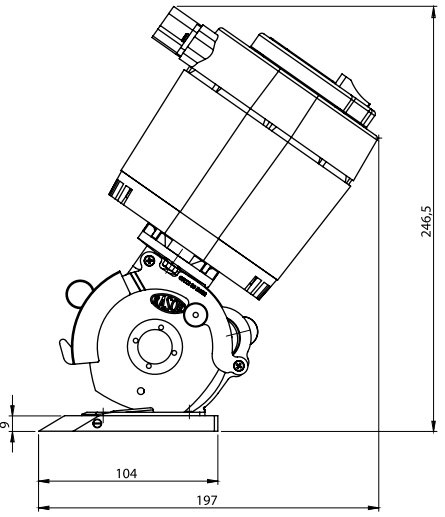
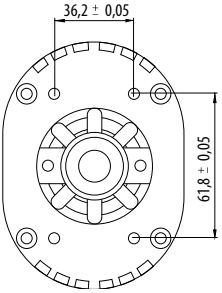
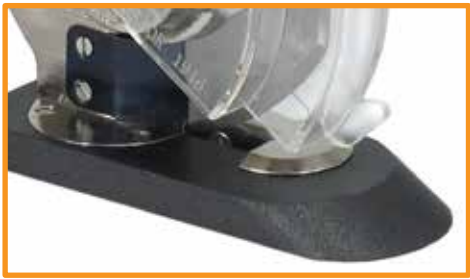

DESCRIPTION

D86PS2 is the smallest single-phase cutting unit with a widia counterblade. For over 25 years within the market, it is installed on the most popular tenters models. D86PS2 weighs less than 3Kilos within a limited overall dimensions. The 5-edge knife assure a sharp and precise cut without rag grinding. The new semiautomatic stone sharpening system aloows the sharpening of the knife edge to be done in only 10 seconds without removing the knife. This model (D86PS2) is widely applied in textile field and in leather and light carpets industries. It is especially suitable for the transversal cut due to its anchor flange which allows an easy fitting on fixed or automatic stirrup. The new mini aluminium Teflon® coated base of this cutting unit allows its installation on sliding rails within a short space. The few maintenance and low operation cost make D86PS2 to be the cheappest and most reliable cutting solution in any of your O.E.M. application.

BLADES Ø 86 MM



86THSS 86PHSS 86THSSTN 86PHSSTF 86THSSTF 86TMD

ACCESSORIES

- Grinders SW1086DIA, SW1081TN
- Blocking Pins T107600
- Butterfly Keys T107500
- Remote handles RHA1
- Stopper S30-03
- Trailers C30-03, C30-0302, C30-0301
- Rail G30-03
- Gear Grease T107900, T107901
- Metal Gloves GMT-REV

SW100S

SINGLEPHASE CUTTING UNITS

SPECIFICATIONS

Blade diameter: 100 mm (4"), with hard metal counterblade
Blade descr.: 10EHSS, 6-edges, HSS steel
Blade speed: 850 r.p.m.
Cutting ability: 35 mm (1.4")
Power: singlephase – 90 W
Max absorption: 2 A
Net weight (with power supply cord): 2650 g
Total weight (with packaging): 4750 g
Electric cable length: 1.5 mt (with no plug)
Minimum brightness for working operations: 200 LUX
Vibrations at start up: < 2.5 m/sec 2
Temperature range: 0 – 55 C
Umidity range: 10 – 95% without condensate

* This model is also available in left side version (specular) as model **SW100SL**.

SAFETY

Main power switch with Led indicator
 Heigh-adjustable trasparent fore blade protection
 Fixed trasparent back blade protection
 Double electric insulation



Check the product
on our website



DESCRIPTION

For over 35 years within the market, SW100S is the most efficient and popular single-phase cutting unit in textile and technical fabrics fields. It reaches the highest level of technology and safety and guarantee power and reliability in less than 3 Kg. weight. The combination between blade and countblade allows a sharp and precise cut without any rag grinding. The 90Watt balanced and silenced motor combined with a high resistance bronze/steel gear couplings create a long lasting stability. The 6-edge 100mm diameter knife allows to cut any fabric up to 35mm thickness. SW100S is especially suitable to the transversal cut because it is arranged with an anchor flange easy to be fitted on fixed or automatic stirrup. The base is Teflon® coated so to allow an easy feed by reducing the friction between the base and the fabric and It is possible to install this cutting unit on slinding rails within a minimun space. The push button sharpening stone system allows the sharpening of the knife edge in less than 10 sec. without removing the knife. For the continuous trimming process SW100S is also available in left side version (specular) as model SW100SL. The few maintenance and low operation cost make model SW100S to be the cheappest and most reliable cutting solution in any of your O.E.M. application.

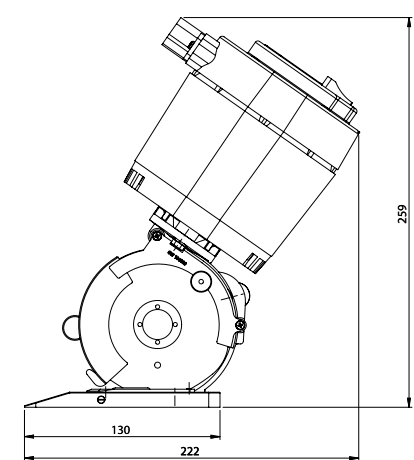

ACCESSORIES

Grinders SW1086DIA,
SW1081TN
Blocking Pins T107600
Butterfly Keys T107500
Remote handles RHA1
Stopper S30-03

Trailers C30-03, C30-0302,
C30-0301
Rail G30-03
Gear Grease T107900, T107901
Metal Gloves GMT-REV

BLADES Ø 100 MM



10EHSS

10CSW

10SEXTG

10EHSSTF

10EMD

SW100SL

SINGLEPHASE CUTTING UNITS

SPECIFICATIONS

Blade diameter: 100 mm (4"), with hard metal counterblade
Blade descr.: 10EHSS, 6-edges, HSS steel
Blade speed: 850 r.p.m.
Cutting ability: 35 mm (1.4")
Power: singlephase – 90 W
Max absorption: 2 A
Net weight (with power supply cord): 2650 g
Total weight (with packaging): 4750 g
Electric cable length: 1.5 mt (with no plug)
Minimum brightness for working operations: 200 LUX
Vibrations at start up: < 2.5 m/sec 2
Temperature range: 0 – 55 C
Umidity range: 10 – 95% without condensate

* This model is also available in right side version (specular) as model **SW100S**.

SAFETY

Main power switch with Led indicator
 Heigh-adjustable trasparent fore blade protection
 Fixed trasparent back blade protection
 Double electric insulation



DESCRIPTION

For over 35 years within the market, SW100SL is the most efficient and popular single-phase cutting unit in textile and technical fabrics fields. It reaches the highest level of technology and safety and guarantee power and reliability in less than 3 Kg. weight. The combination between blade and countblade allows a sharp and precise cut without any rag grinding. The 90Watt balanced and silenced motor combined with a high resistance bronze/steel gear couplings create a long lasting stability. The 6-edge 100mm diameter knife allows to cut any fabric up to 35mm thickness. SW100SL is especially suitable to the transversal cut because it is arranged with an anchor flange easy to be fitted on fixed or automatic stirrup. The base is Teflon® coated so to allow an easy feed by reducing the friction between the base and the fabric and It is possible to install this cutting unit on slinding rails within a minimun space. The new push button sharpening stone system allows the sharpening of the knife edge in less than 10 sec. without removing the knife. For the continuous trimming process SW100SL is also available in right side version (specular) as model SW100S. The few maintenance and low operation cost make model SW100SL to be the cheappest and most reliable cutting solution in any of your O.E.M. application.

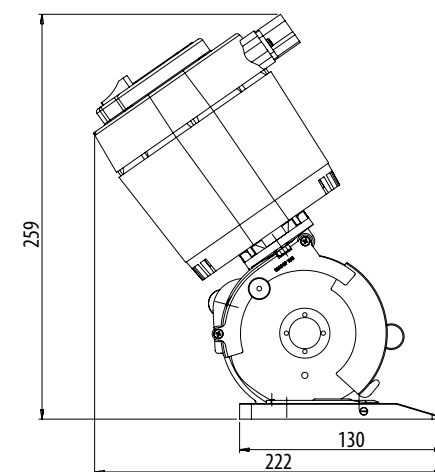
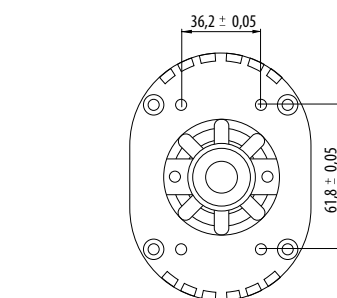

ACCESSORIES

Grinders SW1086DIA,
SW1081TN
Blocking Pins T107600
Butterfly Keys T107500
Remote handles RHA1
Stopper S30-03

Trailers C30-03, C30-0302,
C30-0301
Rail G30-03
Gear Grease T107900, T107901
Metal Gloves GMT-REV

BLADES Ø 100 MM



10EHSS

10CSW

10SEXTG

10EHSSTF

10EMD

SW12S

SINGLEPHASE CUTTING UNITS

SPECIFICATIONS

Blade diameter: 120 mm (4.7"), with hard metal counterblade
Blade descr.: 12SHSS, 8-edges, HSS steel
Blade speed: 850 r.p.m.
Cutting ability: 50 mm (2")
Power: singlephase – 180 W
Max absorption: 2.5 A
Net weight (with power supply cord): 4500 g
Total weight (with packaging): 6200 g
Electric cable length: 1.5 mt (with no plug)
Minimum brightness for working operations: 200 LUX
Vibrations at start up: < 2.5 m/sec 2
Temperature range: 0 – 55 C
Umidity range: 10 – 95% without condensate

* This model is also available in left side version (specular) as model **SW12SSX**

SAFETY

Main power switch with Led indicator
 Heigh-adjustable trasparent fore blade protection
 Fixed trasparent back blade protection
 Double electric insulation

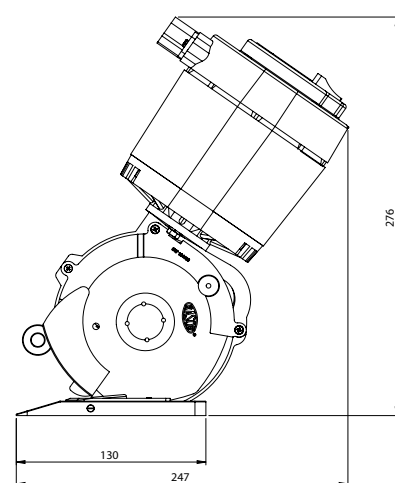
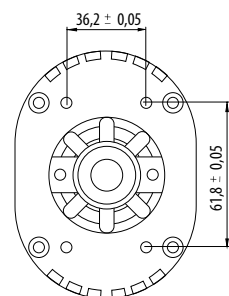

Check the product
on our website



DESCRIPTION

SW12S is a cutting unit for high thickness suitable for application in textile and technical fabrics fields. It reaches the highest level in technology and safety. It weighs 3Kg only but guarantee power and high thickness cutting reliability. The combination system of blade and counteblade allows sharp and precise cut without rag grinding. Its 180Watt balanced and silenced motor combined with high resistance bronze/steel gear couplings create a long lasting stability. The 8-edge 120mm diameter knife allows the cut of any fabric up to 50mm thickness even in multiple layers. SW12S base is Teflon® coated to be friction-free between the base and the fabric. It is possible to install this cutting unit on slinding rails within a minimun space. The push button sharpening stone system allows the sharpening of the knife edge in less than 10 seconds without removing the knife. This model is especially suitable to the transversal cut being arranged with an anchor flange which allows an easy fit on fixed or automatic stirrup. For the continuous trimming process model SW12S is also available in left side version (specular) as model SW12SSX.



ACCESSORIES

Grinders SW1286DIA,
SW1081TN
Blocking Pins T107600
Butterfly Keys T107500
Remote handles RHA1
Stopper S30-03

Trailers C30-03, C30-0302,
C30-0301
Rail G30-03
Gear Grease T107900, T107901
Metal Gloves GMT-REV

BLADES Ø 120 MM



12SHSS

12CHSS

12SHSSTN

12SHSSTF

12SMD

APPLICATIONS

TEXTILE TECHNICAL TEXTILE

APPLICATIONS

TEXTILE TECHNICAL TEXTILE



Check the product
on our website



DESCRIPTION

SW12SSX is a cutting unit for high thickness suitable for application in textile and technical fabrics fields. It reaches the highest level in technology and safety. It weighs 3Kg only but guarantee power and high thickness cutting reliability. The combination system of blade and counteblade allows sharp and precise cut without rag grinding. Its 180Watt balanced and silenced motor combined with high resistance bronze/steel gear couplings create a long lasting stability. The 8-edge 120mm diameter knife allows the cut of any fabric up to 50mm thickness even in multiple layers. SW12SSX base is Teflon® coated to be friction-free between the base and the fabric. It is possible to install this cutting unit on slinding rails within a minimun space. The push button sharpening stone system allows the sharpening of the knife edge in less than 10 seconds without removing the knife. This model is especially suitable to the transversal cut being arranged with an anchor flange which allows an easy fit on fixed or automatic stirrup. For the continuous trimming process model SW12SSX is also available in right side version (specular) as model SW12S.



BLADES Ø 120 MM



12SHSS

12CHSS

12SHSSTN

12SHSSTF

12SMD

SW12SSX

SINGLEPHASE CUTTING UNITS

SPECIFICATIONS

Blade diameter: 120 mm (4.7"), with hard metal counterblade
Blade descr.: 12SHSS, 8-edges, HSS steel
Blade speed: 850 r.p.m.
Cutting ability: 50 mm (2")
Power: singlephase – 180 W
Max absorption: 2.5 A
Net weight (with power supply cord): 4500 g
Total weight (with packaging): 6200 g
Electric cable length: 1.5 mt (with no plug)
Minimum brightness for working operations: 200 LUX
Vibrations at start up: < 2.5 m/sec 2
Temperature range: 0 – 55 C
Umidity range: 10 – 95% without condensate

* This model is also available in right side version (specular) as model **SW12S**

SAFETY

Main power switch with Led indicator
 Heigh-adjustable trasparent fore blade protection
 Fixed trasparent back blade protection
 Double electric insulation

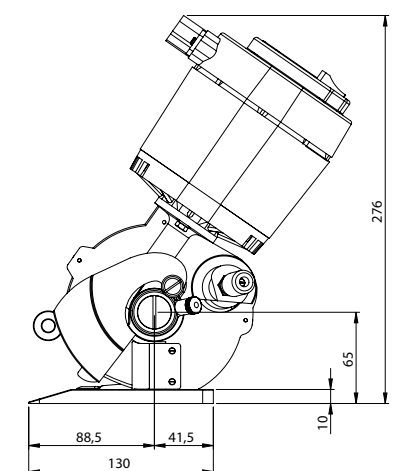
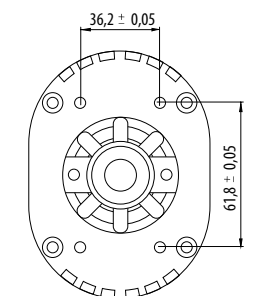

ACCESSORIES

Grinders SW1286DIA,
SW1081TN
Blocking Pins T107600
Butterfly Keys T107500
Remote handles RHA1
Stopper S30-03

Trailers C30-03, C30-0302,
C30-0301
Rail G30-03
Gear Grease T107900, T107901
Metal Gloves GMT-REV

SW12SM

SINGLEPHASE CUTTING UNITS

SPECIFICATIONS

Blade diameter: 120 mm (4.7"), with hard metal counterblade
Blade descr.: 12SHSS, 8-edges, HSS steel
Blade speed: 550 r.p.m.
Cutting ability: 50 mm (2")
Power: singlephase – 350 W
Max absorption: 2.5 A
Net weight (with power supply cord): 4500 g
Total weight (with packaging): 6200 g
Electric cable length: 1.5 mt (with no plug)
Minimum brightness for working operations: 200 LUX
Vibrations at start up: < 2.5 m/sec 2
Temperature range: 0 – 55 C
Umidity range: 10 – 95% without condensate

* This model is also available in left side version (specular) as model **SW12SSM**

SAFETY

Main power switch with Led indicator
 Heigh-adjustable trasparent fore blade protection
 Fixed trasparent back blade protection
 Double electric insulation

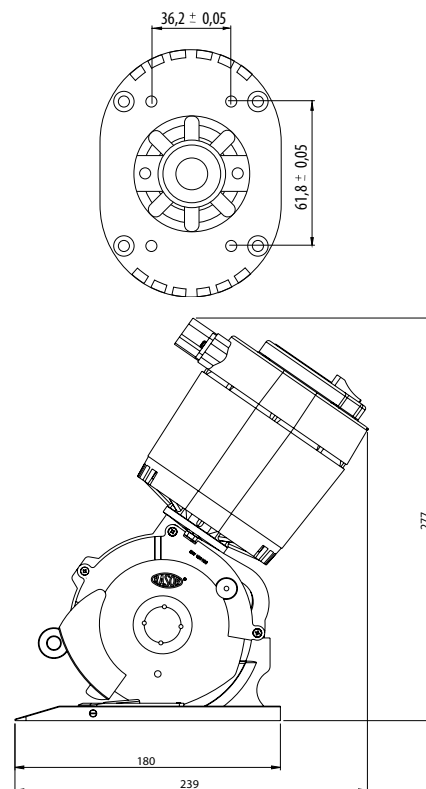

DESCRIPTION

SW12SM is a new generation cutting unit for high thickness. Launched on the market only few years ago SW12SM gives its excellency to the new geometry of the motor housing of Monster series. The difference between SW12SM and the other Rasor's cutting units is given by its motor housing held by a central foot fitted behind the blade in central position. This system spreads the shearing stress and the necessary stress to move the machine through the fabrics on both sides of the cutter and cut is so done perfectly straight and smooth. The knife is half-free on both sides to avoid winding problems even with tough fibers. SW12SM is especially suitable to cut composite materials like glass fiber, carbon fiber and kevlar. The impressive 350 Watt motor combined with a bronze/steel coupling gear develop a very high torque. SW12SM is able to cut any material at the "soft" stage un tp maximun 50 mm of thickness. High torque combined with the slow RPM of the knife allow to cut even rubber materials and plastic based material in the field of carpets and industrial flooring in multi-layers. The push button sharpening stone allows the sharpening of the knife edge to be done in less than 10 seconds without removing the knife. The aluminium cutting base is Teflon® coated to allow the easy run of the machine and the reduction of the friction between the base and the material. SW12SM is especially suitable for the transversal cut and it arranged with an anchor flange to be easily adjusted on fixed or automated hanger. For 24-hours a day trimming SW12SM is also available in left version (specular) as model SW12SSM.



ACCESSORIES

Grinders SW1286DIA,
 SW1081TN
 Blocking Pins T107600
 Butterfly Keys T107500
 Remote handles RHA1
 Stopper S30-03

Trailers C30-03, C30-0302,
 C30-0301
 Rail G30-03
 Gear Grease T107900, T107901
 Metal Gloves GMT-REV

BLADES Ø 120 MM



APPLICATIONS

TEXTILE TECHNICAL TEXTILE COMPOSITE



MONSTER

Check the product
 on our website



APPLICATIONS

TEXTILE TECHNICAL TEXTILE COMPOSITE



MONSTER



Check the product
 on our website



DESCRIPTION

SW12SSM is a new generation cutting unit for high thickness. Launched on the market only few years ago SW12SSM gives its excellency to the new geometry of the motor housing of Monster series. The difference between SW12SSM and the other Rasor's cutting units is given by its motor housing held by a central foot fitted behind the blade in central position. This system spreads the shearing stress and the necessary stress to move the machine through the fabrics on both sides of the cutter and cut is so done perfectly straight and smooth. The knife is half-free on both sides to avoid winding problems even with tough fibers. SW12SSM is especially suitable to cut composite materials like glass fiber, carbon fiber and kevlar. The impressive 350 Watt motor combined with a bronze/steel coupling gear develop a very high torque. SW12SSM is able to cut any material at the "soft" stage un tp maximun 50 mm of thickness. High torque combined with the slow RPM of the knife allow to cut even rubber materials and plastic based material in the field of carpets and industrial flooring in multi-layers. The push button sharpening stone allows the sharpening of the knife edge to be done in less than 10 seconds without removing the knife. The aluminium cutting base is Teflon® coated to allow the easy run of the machine and the reduction of the friction between the base and the material. SW12SSM is especially suitable for the transversal cut and it arranged with an anchor flange to be easily adjusted on fixed or automated hanger. For 24-hours a day trimming SW12SSM is also available in right version (specular) as model SW12SM.



BLADES Ø 120 MM



SW12SSM

SINGLEPHASE CUTTING UNITS

SPECIFICATIONS

Blade diameter: 120 mm (4.7"), with hard metal counterblade
Blade descr.: 12SHSS, 8-edges, HSS steel
Blade speed: 550 r.p.m.
Cutting ability: 50 mm (2")
Power: singlephase – 350 W
Max absorption: 2.5 A
Net weight (with power supply cord): 4500 g
Total weight (with packaging): 6200 g
Electric cable length: 1.5 mt (with no plug)
Minimum brightness for working operations: 200 LUX
Vibrations at start up: < 2.5 m/sec 2
Temperature range: 0 – 55 C
Umidity range: 10 – 95% without condensate

* This model is also available in right side version (specular) as model **SW12SM**

SAFETY

Main power switch with Led indicator
 Heigh-adjustable trasparent fore blade protection
 Fixed trasparent back blade protection
 Double electric insulation

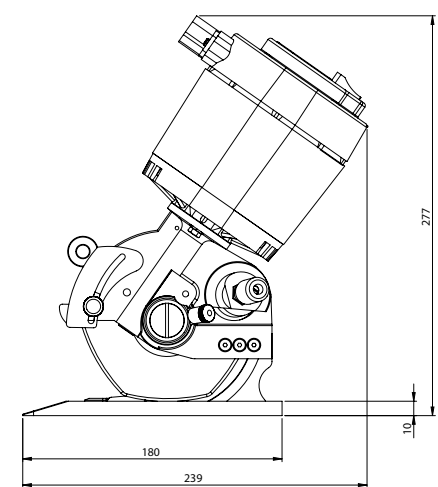
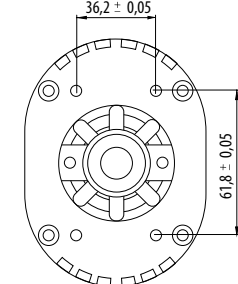

ACCESSORIES

Grinders SW1286DIA,
 SW1081TN
 Blocking Pins T107600
 Butterfly Keys T107500
 Remote handles RHA1
 Stopper S30-03

Trailers C30-03, C30-0302,
 C30-0301
 Rail G30-03
 Gear Grease T107900, T107901
 Metal Gloves GMT-REV

A close-up photograph of a woven fabric, likely a technical textile, showing a distinct diagonal crease. The fabric has a complex, interlocking weave pattern in shades of grey and white. The lighting highlights the texture and the sharpness of the fold.

SILENCE & QUALITY

3-Phases cutting units

APPLICATIONS

TEXTILE

TECHNICAL TEXTILE

GRT-MINI

3-PHASES CUTTING UNITS



Check the product
on our website



SPECIFICATIONS

Blade diameter: 86 mm (3.4"), with hard metal counterblade

Blade descr.: 86PHSS, 5-edges, HSS steel

Blade speed: 550 r.p.m.

Cutting ability: 25 mm (1")

Motor: 3-phases asynchronous 380/400* V, 50 Hz

Power: 55 W

Consumption: 0.3 A

Protection: IP20 – CL F

Net weight (with power supply cord): 2650 g

Total weight (with packaging): 4750 g

Electric cable length: 1.5 mt (with no plug)

Minimum brightness for working operations: 200 LUX

Vibrations at start up: < 2.5 m/sec 2

Temperature range: 0 – 55 C

Umidity range: 10 – 95% without condensate

* This model can be set up at 3-phase 220 V

* On request: 480 V, 60 Hz

SAFETY

Heigh-adjustable trasparent fore blade protection

Fixed trasparent back blade protection

CLF - IP20 electric insulation

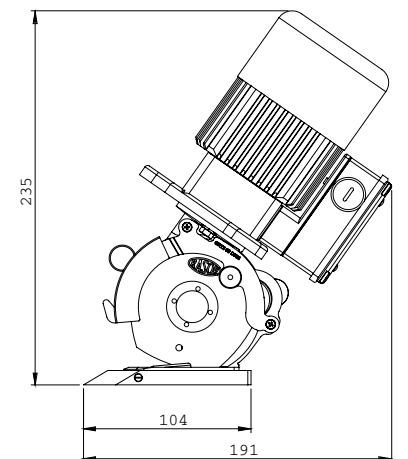
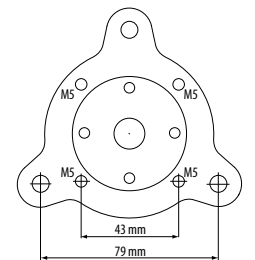

DESCRIPTION

Model GRT-MINI is the smallest three-phase cutting unit with carbide counter-blade. For many years within the market it is installed on the main tentering machines. GRT-MINI is powerfull, small and light (less than 3 Kg.). The 5-edges knife guarantee a clean cut without rag grinding. The new semi-utomatic sharpening stone allows the sharpening of the knife edge to be done in less than 10 secons without removing the knife. GRT-MINI is widely applied in textile, leather, light carpet or technical fabrics field. The three-phase induction motor is balanced and noiseless. This cutting unit does not need any maintenance so to be easily used during the production process on 24 hours-a-day. It is especially suitable for the transversal cut and it arranged with an anchor flange to be easily adjusted on fixed or automated hanger. The new Teflon® coated base is miniaturized so that can be installed on sliding rails within a small space. The minimun maintenance and the minimum handling costs make GRT-MINI the cheap and reliable cutting solution for any O.E.M. application.



BLADES Ø 86 MM



86THSS

86PHSS

86THSSTN

86PHSSTF

86THSSTF

86TMD

ACCESSORIES

Grinders SW1086DIA,
SW1081TN
Blocking Pins T107600
Butterfly Keys T107500
Stopper S30-03

Trailers C30-03, C30-0302,
C30-0301
Rail G30-03
Gear Grease T107900, T107901
Metal Gloves GMT-REV

GRT-MINIV

3-PHASES CUTTING UNITS

SPECIFICATIONS

Blade diameter: 86 mm (3.4"), with hard metal counterblade
Blade descr.: 86PHSS, 5-edges, HSS steel
Blade speed: 550 r.p.m.
Cutting ability: 25 mm (1")
Motor: 3-phases asynchronous 380/400* V, 50 Hz
Power: 55 W
Consumption: 0.3 A
Protection: IP20 – CL F
Net weight (with power supply cord): 2650 g
Total weight (with packaging): 4750 g
Electric cable length: 1.5 mt (with no plug)
Minimum brightness for working operations: 200 LUX
Vibrations at start up: < 2.5 m/sec 2
Temperature range: 0 – 55 C
Umidity range: 10 – 95% without condensate

* This model can be set up at 3-phase 220 V
 * On request: 480 V, 60 Hz

SAFETY

Heigh-adjustable trasparent fore blade protection
 Fixed trasparent back blade protection
 CLF - IP20 electric insulation

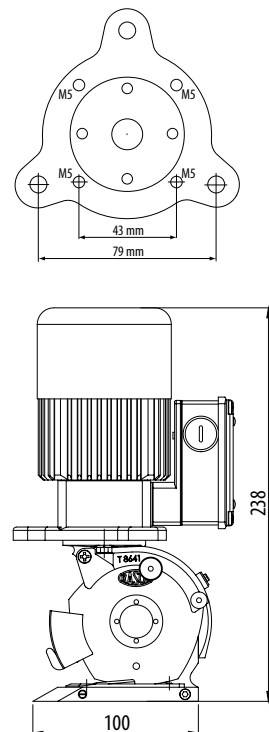

Check the product
on our website



DESCRIPTION

Model GRT-MINIV is the smallest three-phase cutting unit with carbide counter-blade. For many years within the market it is installed on the main tentering machines. GRT-MINIV is powerfull, small and light (less than 3 Kg.). Contrary to all the other Rasor models, GRT-MINIV has a motor installed in vertical position, upright to the cutting direction. The 5-edges knife guarantee a clean cut without rag grinding. The new semi-utomatic sharpening stone allows the sharpening of the knife edge to be done in less than 10 secons without removing the knife. GRT-MINIV is widely applied in textile, leather, light carpet or technical fabrics field. The three-phase induction motor is balanced and noiseless. This cutting unit does not need any maintenance so to be easily used during the production process on 24 hours-a-day. It is especially suitable for the transversal cut and it arranged with an anchor flange to be easily adjusted on fixed or automated hanger. The new aluminium miniaturated base is Teflon® coated so to reduce the friction with the fabric and to allow an easy installation on sliding rails within a small space. The minimun maintenance and the minimun handling costs make GRT-MINIV the cheap and reliable cutting solution for any O.E.M. application.



ACCESSORIES

Grinders SW1086DIA,
SW1081TN
Blocking Pins T107600
Butterfly Keys T107500
Stopper S30-04

Trailers C30-04, C30-0402,
C30-0401
Rail G30-04
Gear Grease T107900, T107901
Metal Gloves GMT-REV

BLADES Ø 86 MM



86THSS

86PHSS

86THSSTN

86PHSSTF

86THSSTF

86TMD

GRT10

3-PHASES CUTTING UNITS

SPECIFICATIONS

Blade diameter: 100 mm (4"), with hard metal counterblade
Blade descr.: 10EHSS, 6-edges, HSS steel
Blade speed: 550 r.p.m.
Cutting ability: 35 mm (1.4")
Motor: 3-phases asynchronous 380/400* V, 50 Hz
Power: 75 W
Consumption: 0.36 A
Protection: IP20 – CL F
Net weight (with power supply cord): 2800 g
Total weight (with packaging): 4500 g
Electric cable length: 1.5 mt (with no plug)
Minimum brightness for working operations: 200 LUX
Vibrations at start up: < 2.5 m/sec 2
Temperature range: 0 – 55 C
Umidity range: 10 – 95% without condensate

* This model is also available in left side version (specular) as model **GRT10L**
 * This model can be set up at 3-phase 220 V
 * On request: 480 V, 60 Hz

SAFETY

Heigh-adjustable trasparent fore blade protection
 Fixed trasparent back blade protection
 CLF - IP20 electric insulation



DESCRIPTION

Model GRT10 is a reliable thre-phase cutting unit applied in the textile or technical fabric fields. GRT10 reached the highest level in technology and safety. GRT10 is powerfull, reliable and light (less than 3 Kg.). The cutting combination between knife and counter-blade guarantee clean cut without rag grinding. The three-phase induction motor is balanced and noiseless. This cutting unit does not need any maintenance so to be easily used during the production process on 24 hours-a-day. The 6-edges 100mm knife allows a cutting thickness up to 35mm. GRT10 is especially suitable for the transversal cut and it arranged with an anchor flange to be easily adjusted on fixed or automated hanger. The aluminium base is Teflon® coated to avoid any friction with the material and can be installed on sliding rails within a small space. The semi-utomatic sharpening stone allows the sharpening of the knife edge to be done in less than 10 seconds without removing the knife. For the stepless trimming process GRT10 is also available in the left version (specular) as model GRT10L. The minimun maintenance and the minimun handling costs make GRT10 the most powerfull and reliable cutting solution for any O.E.M. application.

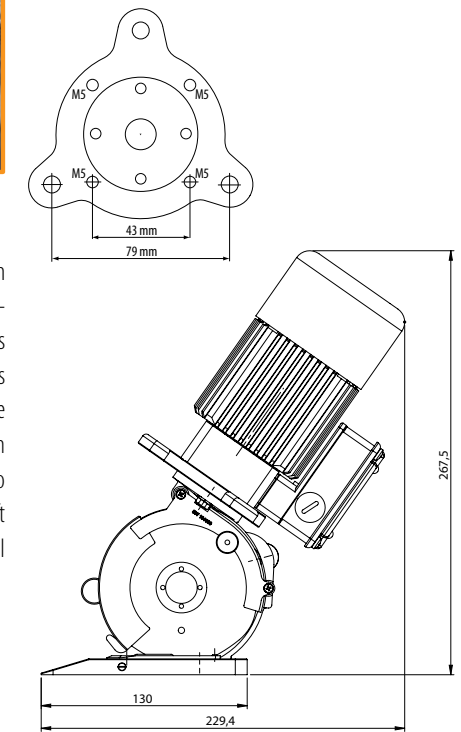

ACCESSORIES

Grinders SW1086DIA,
SW1081TN
Blocking Pins T107600
Butterfly Keys T107500
Stopper S30-03

Trailers C30-03, C30-0302,
C30-0301
Rail G30-03
Gear Grease T107900, T107901
Metal Gloves GMT-REV

BLADES Ø 100 MM



10EHSS

10CSW

10SEXTG

10EHSSTF

10EMD

GRT10L

3-PHASES CUTTING UNITS

SPECIFICATIONS

Blade diameter: 100 mm (4"), with hard metal counterblade
Blade descr.: 10EHSS, 6-edges, HSS steel
Blade speed: 550 r.p.m.
Cutting ability: 35 mm (1.4")
Motor: 3-phases asynchronous 380/400* V, 50 Hz
Power: 75 W
Consumption: 0.36 A
Protection: IP20 – CL F
Net weight (with power supply cord): 2800 g
Total weight (with packaging): 4500 g
Electric cable length: 1.5 mt (with no plug)
Minimum brightness for working operations: 200 LUX
Vibrations at start up: < 2.5 m/sec 2
Temperature range: 0 – 55 C
Umidity range: 10 – 95% without condensate

* This model is also available in right side version (specular) as model **GRT10**
 * This model can be set up at 3-phase 220 V
 * On request: 480 V, 60 Hz

SAFETY

Heigh-adjustable trasparent fore blade protection
 Fixed trasparent back blade protection
 CLF - IP20 electric insulation

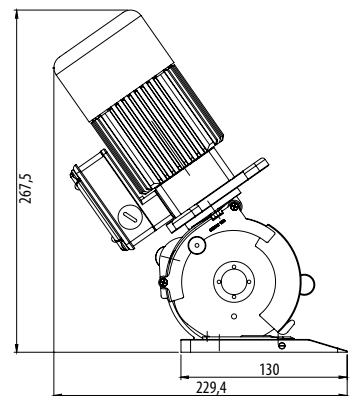
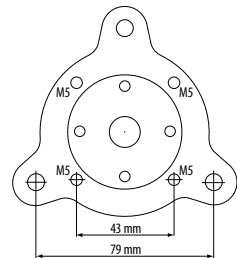

Check the product
on our website



DESCRIPTION

Model GRT10L is a reliable three-phase cutting unit applied in the textile or technical fabric fields. GRT10L reached the highest level in technology and safety. GRT10L is powerfull, reliable and light (less than 3 Kg.). The cutting combination between knife and counter-blade guarantee clean cut without rag grinding. The three-phase induction motor is balanced and noiseless. This cutting unit does not need any maintenance so to be easily used during the production process on 24 hours-a-day. The 6-edges 100mm knife allows a cutting thickness up to 35mm. GRT10L is especially suitable for the transversal cut and it arranged with an anchor flange to be easily adjusted on fixed or automated hanger. The aluminium base is Teflon® coated to avoid any friction with the material and can be installed on sliding rails within a small space. The new semi-utomatic sharpening stone allows the sharpening of the knife edge to be done in less than 10 seconds without removing the knife. For the stepless trimming process GRT10L is also available in the right version (specular) as model GRT10. The minimun maintenance and the minimun handling costs make GRT10L the most powerfull and reliable cutting solution for any O.E.M. application.



ACCESSORIES

Grinders SW1086DIA,
SW1081STN
Blocking Pins T107600
Butterfly Keys T107500
Stopper S30-03

Trailers C30-03, C30-0302,
C30-0301
Rail G30-03
Gear Grease T107900, T107901
Metal Gloves GMT-REV

BLADES Ø 100 MM



GRT12

3-PHASES CUTTING UNITS

SPECIFICATIONS

Blade diameter: 120 mm (4.7"), with hard metal counterblade
Blade descr.: 12SHSS, 8-edges, HSS steel
Blade speed: 400 r.p.m.
Cutting ability: 50 mm (2")
Motor: 3-phases asynchronous 380/400* V, 50 Hz
Power: 180 W
Consumption: 0.52 A
Protection: IP20 – CL F
Net weight (with power supply cord): 4650 g
Total weight (with packaging): 6350 g
Electric cable length: 1.5 mt (with no plug)
Minimum brightness for working operations: 200 LUX
Vibrations at start up: < 2.5 m/sec 2
Temperature range: 0 – 55 C
Umidity range: 10 – 95% without condensate

* This model is also available in left side version (specular) as model **GRT12SX**
 * This model can be set up at 3-phase 220 V
 * On request: 480 V, 60 Hz

SAFETY

Heigh-adjustable trasparent fore blade protection
 Fixed trasparent back blade protection
 CLF - IP20 electric insulation

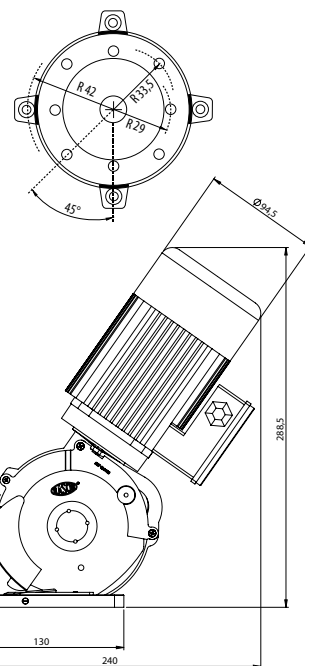

DESCRIPTION

Model GRT12 is a three-phase cutting unit suitable to cut high thickness in the textile or technical fabric fields. GRT12 reached the highest level in technology and safety. GRT12 is powerfull, reliable and light (4Kg only). The cutting combination between knife and counter-blade guarantee clean cut without rag grinding. The three-phase induction motor is balanced and noiseless. This cutting unit does not need any maintenance so to be easily used during the production process on 24 hours-a-day. The 8-edges 120mm knife allows a cutting thickness up to 50mm even for multiple layers. GRT12 is especially suitable for the transversal cut and it arranged with an anchor flange to be easily adjusted on fixed or automated hanger. The aluminium base is Teflon® coated to avoid any friction with the material and can be installed on sliding rails within a small space. The semi-utomatic sharpening stone allows the sharpening of the knife edge to be done in less than 10 seconds without removing the knife. For the stepless trimming process GRT12 is also available in the left version (specular) as model GRT12SX. The minimun maintenance and the minimun handling costs make GRT12 the most powerfull and reliable cutting solution for any O.E.M. application.



BLADES Ø 120 MM



ACCESSORIES

Grinders SW1286DIA,
SW1081TN
Blocking Pins T107600
Butterfly Keys T107500
Stopper S30-03

Trailers C30-03, C30-0302,
C30-0301
Rail G30-03
Gear Grease T107900, T107901
Metal Gloves GMT-REV

GRT12SX

3-PHASES CUTTING UNITS

SPECIFICATIONS

Blade diameter: 120 mm (4.7"), with hard metal counterblade
Blade descr.: 12SHSS, 8-edges, HSS steel
Blade speed: 400 r.p.m.
Cutting ability: 50 mm (2")
Motor: 3-phases asynchronous 380/400* V, 50 Hz
Power: 180 W
Consumption: 0.52 A
Protection: IP20 – CL F
Net weight (with power supply cord): 4650 g
Total weight (with packaging): 6350 g
Electric cable length: 1.5 mt (with no plug)
Minimum brightness for working operations: 200 LUX
Vibrations at start up: < 2.5 m/sec 2
Temperature range: 0 – 55 C
Umidity range: 10 – 95% without condensate

* This model is also available in right side version (specular) as model **GRT12**
 * This model can be set up at 3-phase 220 V
 * On request: 480 V, 60 Hz

SAFETY

Heigh-adjustable trasparent fore blade protection
 Fixed trasparent back blade protection
 CLF - IP20 electric insulation

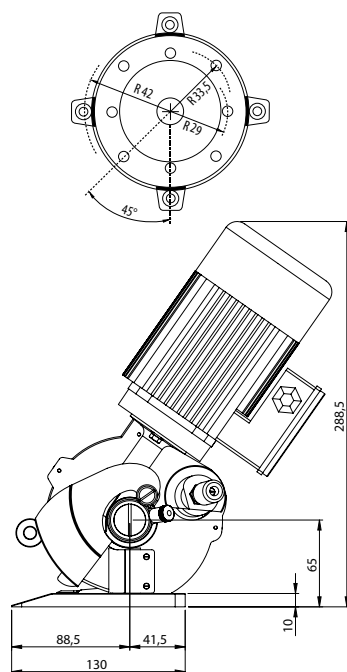

DESCRIPTION

Model GRT12SX is a three-phase cutting unit suitable to cut high thickness in the textile or technical fabric fields. GRT12SX reached the highest level in technology and safety. GRT12SX is powerfull, reliable and light (4Kg only). The cutting combination between knife and counter-blade guarantee clean cut without rag grinding. The three-phase induction motor is balanced and noiseless. This cutting unit does not need any maintenance so to be easily used during the production process on 24 hours-a-day. The 8-edges 120mm knife allows a cutting thickness up to 50mm even for multiple layers. GRT12SX is especially suitable for the transversal cut and it arranged with an anchor flange to be easily adjusted on fixed or automated hanger. The aluminium base is Teflon® coated to avoid any friction with the material and can be installed on sliding rails within a small space. The semi-utomatic sharpening stone allows the sharpening of the knife edge to be done in less than 10 seconds without removing the knife. For the stepless trimming process GRT12SX is also available in the right side version (specular) as model GRT12. The minimun maintenance and the minimun handling costs make GRT12SX the most powerfull and reliable cutting solution for any O.E.M. application.



APPLICATIONS

TEXTILE

TECHNICAL TEXTILE

Check the product
on our website



APPLICATIONS

TECHNICAL TEXTILE

COMPOSITE

Check the product
on our website



MONSTER



GRT12M

3-PHASES CUTTING UNITS

SPECIFICATIONS

Blade diameter: 120 mm (4.7"), with hard metal counterblade
Blade descr.: 12SHSS, 8-edges, HSS steel
Blade speed: 400 r.p.m.
Cutting ability: 50 mm (2")
Motor: 3-phases asynchronous 380/400* V, 50 Hz
Power: 180 W
Consumption: 0.52 A
Protection: IP20 – CL F
Net weight (with power supply cord): 4600 g
Total weight (with packaging): 6300 g
Electric cable length: 1.5 mt (with no plug)
Minimum brightness for working operations: 200 LUX
Vibrations at start up: < 2.5 m/sec 2
Temperature range: 0 – 55 C
Umidity range: 10 – 95% without condensate

* This model is also available in left side version (specular) as model **GRT12SM**
 * This model can be set up at 3-phase 220 V
 * On request: 480 V, 60 Hz

SAFETY

Heigh-adjustable trasparent fore blade protection
 Fixed trasparent back blade protection
 CLF - IP20 electric insulation

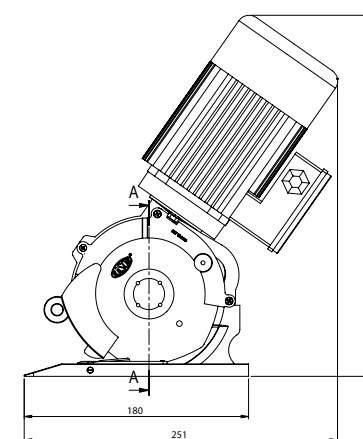
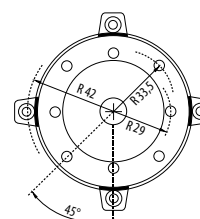

DESCRIPTION

Model GRT12M is a three-phase cutting unit suitable to cut high thickness in the technical fabrics and composite materials. Launched on the market only few years ago GRT12M gives its eccellency to the new geometry of the motor housing of Monster series. The difference between GRT12M and the other Raso's cutting units is given by its motor housing held by a central foot fitted behind the blade in central position. This system spreads the shearing stress and the necessary stress to move the machine through the fabrics on both sides of the cutter and cut is so done perfectly straight and smooth. The knife is half-free on both sides to avoid winding problems even with tough fibers. This is why GRT12M is especially suitable to cut composite materials like glass fiber, carbon fiber and kevlar. The three-phase induction motor is balanced and noiseless. It does not need any maintenance so to be easily used during The production process on 24 hours-a-day. This type of motor together with bronze/steel couplings give the cutting unit to be reliable and resistance in life. The 8-edges 120 mm knife allows a cutting thickness up to 50 mm even for multiple layers. High torque combined with the slow RPM of the knife allow to cut even rubber materials and plastic based material in the field of carpets and industrial flooring. The push button sharpening stone allows the sharpening of the knife edge to be done in less than 10 seconds without removing the knife. The aluminium base is Teflon® coated to reduce friction with the material and can be installed on sliding rails within a small space. GRT12M is especially suitable for the transversal cut and it arranged with an anchor flange to be easily adjusted on fixed or automated hanger. For the stepless trimming process GRT12M is also available in the left side version (specular) as model GRT12SM. The minimun maintenance and the minimun handling costs make GRT12M the most powerfull and reliable cutting solution for any O.E.M. application.



ACCESSORIES

Grinders SW1286DIA,
SW1081STN
Blocking Pins T107600
Butterfly Keys T107500
Stopper S30-03

Trailers C30-03, C30-0302,
C30-0301
Rail G30-03
Gear Grease T107900, T107901
Metal Gloves GMT-REV

BLADES Ø 120 MM



BLADES Ø 120 MM



ACCESSORIES

Grinders SW1286DIA,
SW1081TN
Blocking Pins T107600
Butterfly Keys T107500
Stopper S30-03

Trailers C30-0302, C30-0301
Rail G30-03
Gear Grease T107900, T107901
Metal Gloves GMT-REV

GRT12SM

3-PHASES CUTTING UNITS

SPECIFICATIONS

Blade diameter: 120 mm (4.7"), with hard metal counterblade
Blade descr.: 12SHSS, 8-edges, HSS steel
Blade speed: 400 r.p.m.
Cutting ability: 50 mm (2")
Motor: 3-phases asynchronous 380/400* V, 50 Hz
Power: 180 W
Consumption: 0.52 A
Protection: IP20 – CL F
Net weight (with power supply cord): 4600 g
Total weight (with packaging): 6300 g
Electric cable length: 1.5 mt (with no plug)
Minimum brightness for working operations: 200 LUX
Vibrations at start up: < 2.5 m/sec 2
Temperature range: 0 – 55 C
Umidity range: 10 – 95% without condensate

* This model is also available in right side version (specular) as model **GRT12M**
 * This model can be set up at 3-phase 220 V
 * On request: 480 V, 60 Hz

SAFETY

Heigh-adjustable trasparent fore blade protection
 Fixed trasparent back blade protection
 CLF - IP20 electric insulation

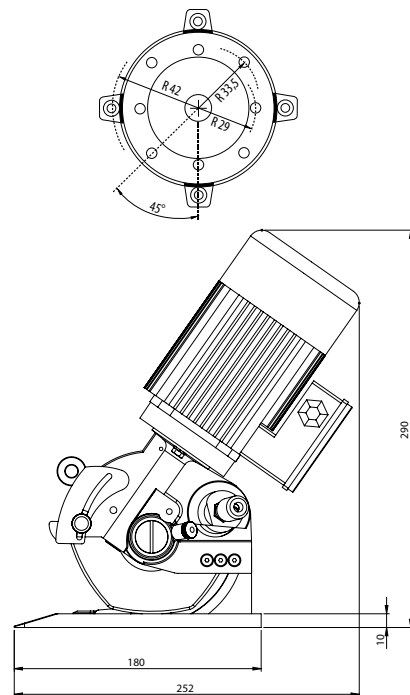

DESCRIPTION

Model GRT12SM is a three-phase cutting unit suitable to cut high thickness in the technical fabrics and composite materials. Launched on the market only a few years ago GRT12SM gives its excellency to the new geometry of the motor housing of Monster series. The difference between GRT12SM and the other Rasor's cutting units is given by its motor housing held by a central foot fitted behind the blade in central position. This system spreads the shearing stress and the necessary stress to move the machine through the fabrics on both sides of the cutter and cut is so done perfectly straight and smooth. The knife is half-free on both sides to avoid winding problems even with tough fibers. This is why GRT12SM is especially suitable to cut composite materials like glass fiber, carbon fiber and kevlar. The three-phase induction motor is balanced and noiseless. It does not need any maintenance so to be easily used during The production process on 24 hours-a-day. This type of motor together with bronze/steel couplings give the cutting unit to be reliable and resistance in life. The 8-edges 120 mm knife allows a cutting thickness up to 50 mm even for multiple layers. High torque combined with the slow RPM of the knife allow to cut even rubber materials and plastic based material in the field of carpets and industrial flooring. The push button sharpening stone allows the sharpening of the knife edge to be done in less than 10 seconds without removing the knife. The aluminium base is Teflon® coated to reduce friction with the material and can be installed on sliding rails within a small space. GRT12SM is especially suitable for the transversal cut and it arranged with an anchor flange to be easily adjusted on fixed or automated hanger. For the stepless trimming process GRT12SM is also available in the right side version (specular) as model GRT12M. The minimun maintenance and the minimun handling costs make GRT12SM the most powerfull and reliable cutting solution for any O.E.M. application.



Check the product
on our website



MONSTER

BLADES Ø 120 MM



ACCESSORIES

Grinders SW1286DIA,
SW1081STN
Blocking Pins T107600
Butterfly Keys T107500
Stopper S30-03

Trailers C30-0302, C30-0301
Rail G30-03
Gear Grease T107900, T107901
Metal Gloves GMT-REV

GRT12DT

3-PHASES CUTTING UNITS



Check the product
on our website



DESCRIPTION

GRT12DT is a three-phase cutting unit suitable to cut high thickness in the technical fabric and composite material fields. Thanks to the double carbide counter-blade GRT12DT is able to cut on both directions (through an inverter). This peculiarity allow to save one run and so time in cross-cut process. The three-phase induction motor is balanced and noiseless. It does not need any maintenance so to be easily used for 24 hours-a-day production process. This type of motor together with bronze/steel couplings give the cutting unit to be reliable and resistance in life. The 8-edges 120mm knife allows a cutting thickness up to 50 mm even for multiple layers. High torque combined with the slow RPM of the knife allow to cut even rubber materials and plastic based material in the field of carpets and industrial flooring. The push button sharpening stone allows the sharpening of the knife edge to be done in less than 10 seconds without removing the knife. The aluminium base is Teflon® coated to reduce friction with the material and can be installed on sliding rails within a small space. GRT12DT is especially suitable for the transversal cut and it arranged with an anchor flange to be easily adjusted on fixed or automated hanger. The powerfull and bi-directional cut make GRT12DT the perfect solution for the most complicate O.E.M application.



BLADES Ø 120 MM



SPECIFICATIONS

Blade diameter: 120 mm (4.7"), with double hard metal counterblade
Blade descr.: 12SHSS, 8-edges, HSS steel
Blade speed: 400 r.p.m.
Cutting ability: 50 mm (2"), bidirectional
Motor: 3-phases asynchronous 380/400* V, 50 Hz
Power: 180 W
Consumption: 0.52 A
Protection: IP20 – CL F
Net weight (with power supply cord): 4590 g
Total weight (with packaging): 6290 g
Electric cable length: 1.5 mt (with no plug)
Minimum brightness for working operations: 200 LUX
Vibrations at start up: < 2.5 m/sec 2
Temperature range: 0 – 55 C
Umidity range: 10 – 95% without condensate

* This model can be set up at 3-phase 220 V
 * On request: 480 V, 60 Hz

SAFETY

Heigh-adjustable trasparent fore blade protection
 Fixed trasparent back blade protection
 CLF - IP20 electric insulation

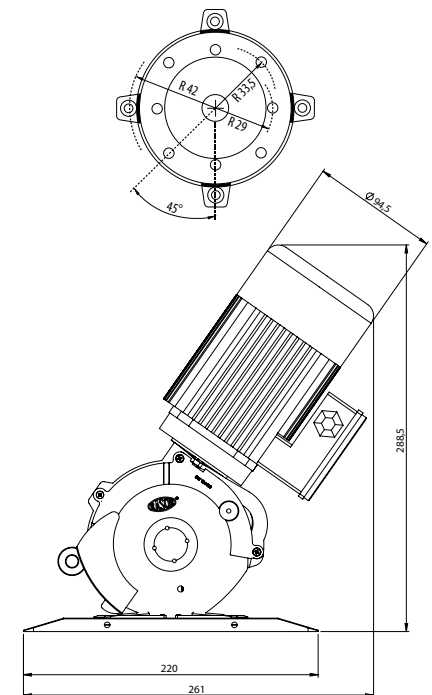

ACCESSORIES

Grinders SW1286DIA,
SW1081TN, SW1081STN
Blocking Pins T107600
Butterfly Keys T107500
Stopper S30-03

Trailers C30-0302
Rail G30-03
Gear Grease T107900, T107901
Metal Gloves GMT-REV



HIGH SPEED CUTTING PROCESS & LOW MAINTENANCE

3-Phases DirectDrive cutting units

APPLICATIONS

TEXTILE
TECHNICAL TEXTILE
COMPOSITE



Check the product
on our website

MONSTER

DD120MR

3-PHASES DIRECTDRIVE CUTTING UNITS

SPECIFICATIONS

Blade diameter: 120 mm (4.7"), with hard metal counterblade, Titanium coated

Blade descr.: 12SDD, 8-edges, HSS steel

Blade speed: 2600 r.p.m.

Cutting ability: 50 mm (2")

Motor: 3-phases asynchronous 380/400* V, 50 Hz

Power: 180 W

Consumption: 0.52 A

Protection: IP20 – CL F

Net weight (with power supply cord): 4000 g

Total weight (with packaging): 5700 g

Electric cable length: 1.5 mt (with no plug)

Minimum brightness for working operations: 200 LUX

Vibrations at start up: < 2.5 m/sec²

Temperature range: 0 – 55 C

Umidity range: 10 – 95% without condensate

* This model is also available in left side version (specular) as model **DD120ML**

* This model can be set up at 3-phase 220 V

* On request: 480 V, 60 Hz

SAFETY

Heigh-adjustable fore blade protection in anodized aluminium

CLF - IP20 electric insulation



DESCRIPTION

The new DD120MR is a three-phase cutting unit for cutting textile, technical fabrics and composite material. That is part of the latest technology of Rasor DirectDrive such as the knife installed on the same axis of the motor. DD120MR has no coupling gear which means no maintenance (i.e. the lubrication with grease) reducing therefore also the operation cost while using during the no-stop 24h/day production processes. The knife can reach a speed of 2600 RPM so this tool comes perfect for the high speed no-stop cutting process. The new particular building geometry "Monster" style avoid totally the trouble on winding for composite material such as the winding of the fiber behind the knife. The cutting system by a knife and counterblade (now Titanium coated) assure a precise and sharp cut without scraps. The induction three-phase motor is balanced and silenced with no maintenance needed assuring reliability for life. The knife is 120 mm diameter 8-edges and allows to reach a cutting thickness of 50 mm even as multi-layers. DD120MR is especially studied for the transversal and no-stop cut and it is arranged with an anchor flange easy to be fitted on fixed or automatic stirrup. The aluminium Teflon® coated base reduce the friction between the foot and the material and allow the easy forward movement even for an installation sliding rails. The push button sharpening stone allows the sharpening of the knife edge to be done in less than 10 seconds without removing the knife. For the no-stop trimming process DD120MR is also available in left version (specular) as model DD120ML. The minimum needed maintenance and low production cost make DD120MR to be a reliable cutting solution in any high speed O.E.M. application.

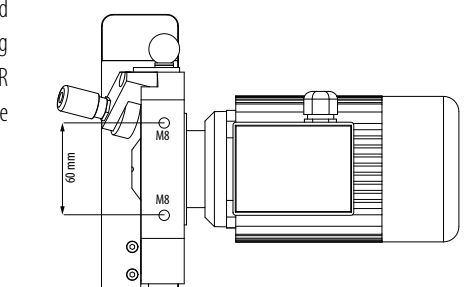
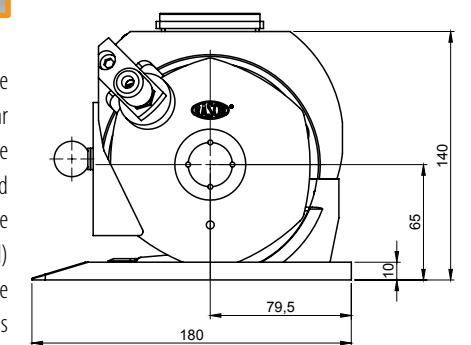

BLADES Ø 120 MM



12SDD



12CDD

ACCESSORIES

Grinders SW1286DIA
Blocking Pins T1076DD
Butterfly Keys T107500
Stopper S30-03

Trailers C30-0301, C30-0302
Rail G30-03
Gear Grease T107901
Metal Gloves GMT-REV

DD120ML

3-PHASES DIRECTDRIVE CUTTING UNITS

SPECIFICATIONS

Blade diameter: 120 mm (4.7"), with hard metal counterblade, Titanium coated
Blade descr.: 12SHSS, 8-edges, HSS steel
Blade speed: 2600 r.p.m.
Cutting ability: 50 mm (2")
Motor: 3-phases asynchronous 380/400* V, 50 Hz
Power: 180 W
Consumption: 0.52 A
Protection: IP20 – CL F
Net weight (with power supply cord): 4000 g
Total weight (with packaging): 5700 g
Electric cable length: 1.5 mt (with no plug)
Minimum brightness for working operations: 200 LUX
Vibrations at start up: < 2.5 m/sec 2
Temperature range: 0 – 55 C
Umidity range: 10 – 95% without condensate

* This model is also available in right side version (specular) as model **DD120MR**
 * This model can be set up at 3-phase 220 V
 * On request: 480 V, 60 Hz

SAFETY

Heigh-adjustable fore blade protection in anodized aluminium
 CLF - IP20 electric insulation

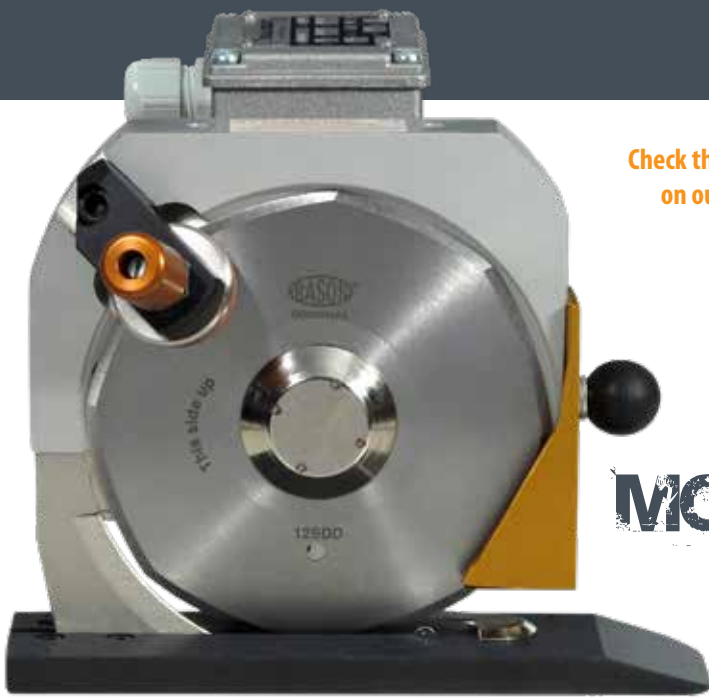
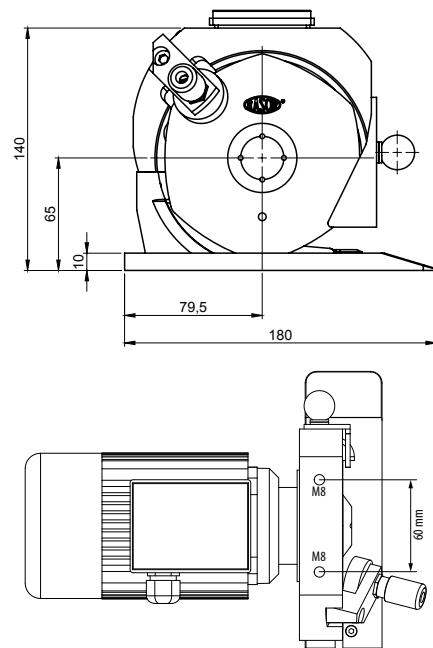

Check the product
on our website



MONSTER



DESCRIPTION

The new DD120ML is a three-phase cutting unit for cutting textile, technical fabrics and composite material. That is part of the latest technology of Rasor DirectDrive such as the knife installed on the same axis of the motor. DD120ML has no coupling gear which means no maintenance (i.e. the lubrication with grease) reducing therefore also the operation cost while using during the no-stop 24h/day production processes. The knife can reach a speed of 2600 RPM so this tool comes perfect for the high speed no-stop cutting process. The new particular building geometry "Monster" style avoid totally the trouble on winding for composite material such as the winding of the fiber behind the knife. The cutting system by a knife and counterblade (now Titanium coated) assure a precise and sharp cut without scraps. The induction three-phase motor is balanced and silenced with no maintenance needed assuring reliability for life. The knife is 120 mm diameter 8-edges and allows to reach a cutting thickness of 50 mm even as multi-layers. DD120ML is especially studied for the transversal and no-stop cut and it is arranged with a anchor flange easy to be fitted on fixed or automatic stirrup. The aluminium Teflon® coated base reduce the friction between the foot and the material and allow the easy forward movement even for an installation sliding rails. The push button sharpening stone allows the sharpening of the knife edge to be done in less than 10 seconds without removing the knife. For the no-stop trimming process DD120ML is also available in right version (specular) as model DD120MR. The minimum needed maintenance and low production cost make DD120ML to be a reliable cutting solution in any high speed O.E.M. application.



ACCESSORIES

Grinders SW1286DIA
 Blocking Pins T1076DD
 Butterfly Keys T107500
 Stopper S30-03

Trailers C30-0301, C30-0302
 Rail G30-03
 Gear Grease T107901
 Metal Gloves GMT-REV

BLADES Ø 120 MM



12SDD

12CDD

APPLICATIONS
 TEXTILE
 TECHNICAL TEXTILE
 COMPOSITE

APPLICATIONS
 TEXTILE
 TECHNICAL TEXTILE
 COMPOSITE



Check the product
on our website



BI-DIRECTIONAL

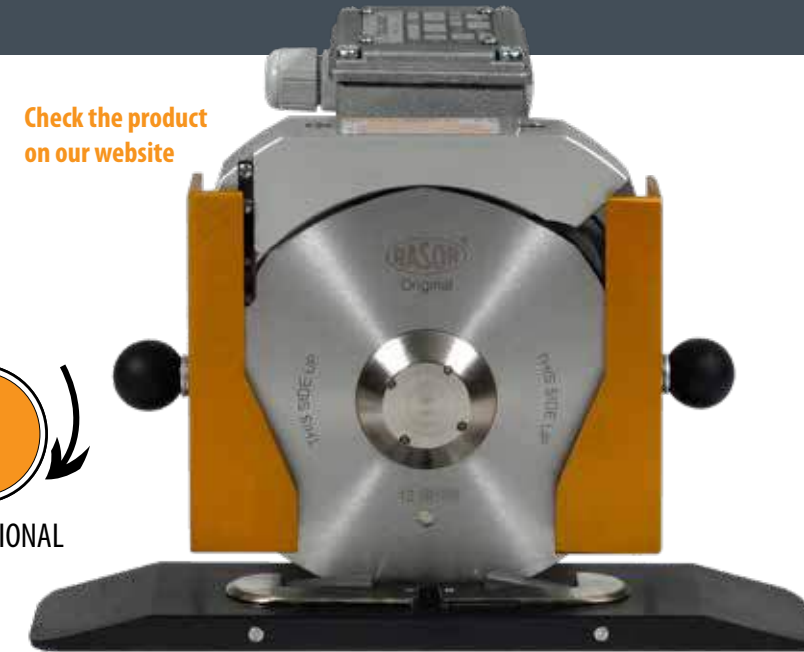

DESCRIPTION

Model DD120DT is a three-phase cutting unit for textile, technical fabrics and composite material. Thanks to the double carbide counter-blade (now Titanium coated) GRT12DT is able to cut on both directions (through an inverter). This peculiarity allow to save one run and so time in cross-cut process. DD120DT is part of new technology of Rasor Direct Drive range which see the knife installed on the same axis of the motor. DD120DT has no coupling gear which means no maintenance (i.e. the lubrication with grease) reducing therefore the operation cost. The knife can reach a speed of 2600 RPM so this tool comes perfect to work at very high speed during no-stop 24h/day cutting process. The combination of knife and counterblade assure a precise and sharp cut without scraps. The induction three-phase motor is balanced and silenced requiring no maintenance while assuring reliability for life. The 8-edges 120 mm knife allows a cutting thickness up to 50 mm even for multiple layers. DD120DT is especially designed for the transversal and no-stop cut and it is arranged with a anchor flange easy to be fitted on fixed or automatic stirrup. The base of DD120DT is Teflon® coated to reduce friction with the material and can be installed on sliding rails within a small space. The push button sharpening stone allows the sharpening of the knife edge to be done in less than 10 seconds without removing the knife. The limited maintenance, the low production cost and the bi-directional function make DD120DT the best reliable solution for any high speed O.E.M. application.



BLADES Ø 120 MM



12SHSS

12CHSS

12SHSSTN

12SHSSTF

12SMD

DD120DT

3-PHASES DIRECTDRIVE CUTTING UNITS

SPECIFICATIONS

Blade diameter: 120 mm (4.7"), with double hard metal counterblade, Titanium coated
Blade descr.: 12SHSS, 8-edges, HSS steel
Blade speed: 2600 r.p.m.
Cutting ability: 50 mm (2"), bidirectional
Motor: 3-phases asynchronous 380/400* V, 50 Hz
Power: 180 W
Consumption: 0.52 A
Protection: IP20 – CL F
Net weight (with power supply cord): 4150 g
Total weight (with packaging): 5850 g
Electric cable length: 1.5 mt (with no plug)
Minimum brightness for working operations: 200 LUX
Vibrations at start up: < 2.5 m/sec 2
Temperature range: 0 – 55 C
Umidity range: 10 – 95% without condensate

* This model can be set up at 3-phase 220 V
 * On request: 480 V, 60 Hz

SAFETY

High-adjustable fore blade protection in anodized aluminium
 High-adjustable back blade protection in anodized aluminium
 CLF - IP20 electric insulation

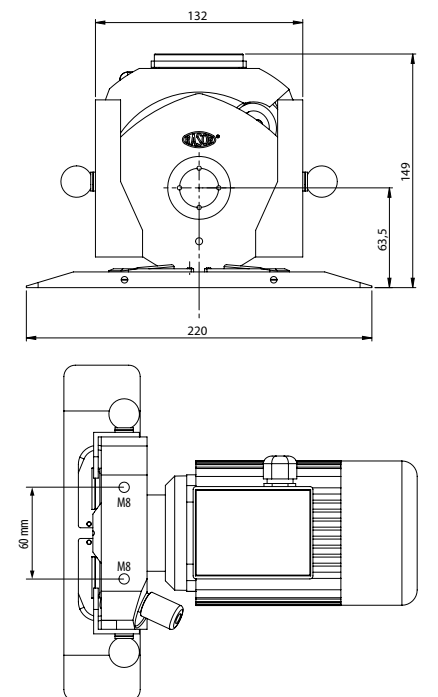

ACCESSORIES

Grinders SW1286DIA
 Blocking Pins T1076DD
 Butterfly Keys T107500
 Stopper S30-03

Trailers C30-0302
 Rail G30-03
 Gear Grease T107901
 Metal Gloves GMT-REV



Accessories

80

BLADES

BLADES Ø 50 MM



BLADES Ø 70 MM



BLADES Ø 86 MM



BLADES Ø 100 MM



BLADES Ø 120 MM



BLADES Ø 200 MM



ACCESSORIES

ACCESSORIES & MODELS

[illegible]

ACCESSORIES

BLADES ACCESSORIES

BUTTERFLY KEYS



T107500



F5059

BLOCKING PINS



T1076DD



T107600



F5057

DIAMOND & TITANIUM KIT

GRINDERS



SW1286DIA



SW1086DIA

COUNTERBLADES



SW1081STN



SW1081TN



F7055TN

BATTERY DRIVEN MACHINE ACCESSORIES

CHARGERS



DK36



CH3601



CH36



CH01



CH02

BATTERIES



BAT18



BAT36

REMOTE HANDLES



RHA1



RHA2

SPECIAL FEET



F5070A



F5070B



F5053/S



F5053/SCPL



P053/1CPL



P053/1SCPL



F7053A

RAIL SYSTEMS

W1040 SERIES



C30-03



C30-0301



C30-0302



G30-03



S30-03

W0630 SERIES



C30-04



C30-0401



C30-0402



G30-04



S30-04

LUBRICANTS

GEAR GREASE



T107900

SPRAY LUBRICANTS



T107901

SAFETY DEVICE

METAL GLOVES



GMT-REV

PNEUMATIC ACCESSORIES

REGULATORS



P168

LUBRICANTS



T107905



T107904

FAST CONNECTORS



P170



P171

TUBE



P173

SILENCERS



P029

DEALERS

EUROPE

| | |
|--------------------|--------------------------|
| BELGIUM | www.garnital.be |
| BOSNIA HERZEGOVINA | www.komas.ba |
| BULGARIA | www.inatrading.com |
| CROATIA | www.intercommerce.hr |
| DENMARK | www.thornberg.dk |
| ESTONIA | www.dermot.ee |
| FINLAND | www.kstarvike.fi |
| | www.adfinnland.fi |
| FRANCE | www.jlperrin.com |
| | www.sodifa-esca.fr |
| GERMANY | www.rh-schneidtechnik.de |
| GREECE | www.androulakis.net.gr |
| | www.karamitsios.gr |
| | www.scissors.gr |
| | www.sierros.gr |
| LATVIA | www.godex.lv |
| LITHUANIA | www.starteksa.lt |
| LUXEMBURG | www.garnital.be |
| NETHERLAND | www.garnital.be |
| NORWAY | www.rosselandas.no |
| | www.amatec.no |
| POLAND | www.polytor.pl |
| PORTUGAL | www.tecnivap.com |
| ROMANIA | www.rasor.ro |
| SERBIA | www.feher.rs |
| SLOVENIJA | www.rigo.si |
| SPAIN | www.reymatex.net |
| SWEDEN | www.texmac.se |
| TURKEY | www.bedirmakina.com |
| UKRAINE | www.shvejnik.uz.ua |
| UNITED KINGDOM | www.jrtech.co.uk |
| | www.chpt.co.uk |
| | www.tacura.co.uk |
| | www.college-sewing.co.uk |

AMERICAS

| | |
|---------------|----------------------|
| CANADA | www.bmbosc.com |
| MEXICO | www.herraplas.mx |
| UNITED STATES | www.sewnproducts.com |

AFRICA

| | |
|--------------|--------------------|
| MOROCCO | www.mabotex.net |
| SOUTH AFRICA | mctsew@iafrica.com |

ASIA

| | |
|-------------|-------------------------|
| CHINA | www.karming.com |
| HONG KONG | www.karming.com |
| INDIA | www.hitechair.com |
| INDONESIA | www.ptsolchem.com |
| IRAN | www.milad-farasoat.com |
| JAPAN | www.mashintex.co.jp |
| MACAU | www.karming.com |
| PAKISTAN | www.unicom.com.pk |
| QATAR | ghazialmannai@yahoo.com |
| SOUTH KOREA | indicator@nate.com |
| TAIWAN | www.karming.com |
| UAE | www.starsew.com |

ACCESSORIES

OCEANIA

| | |
|-----------|------------------------------|
| AUSTRALIA | www.elizabethmachines.com.au |
|-----------|------------------------------|

NOTES

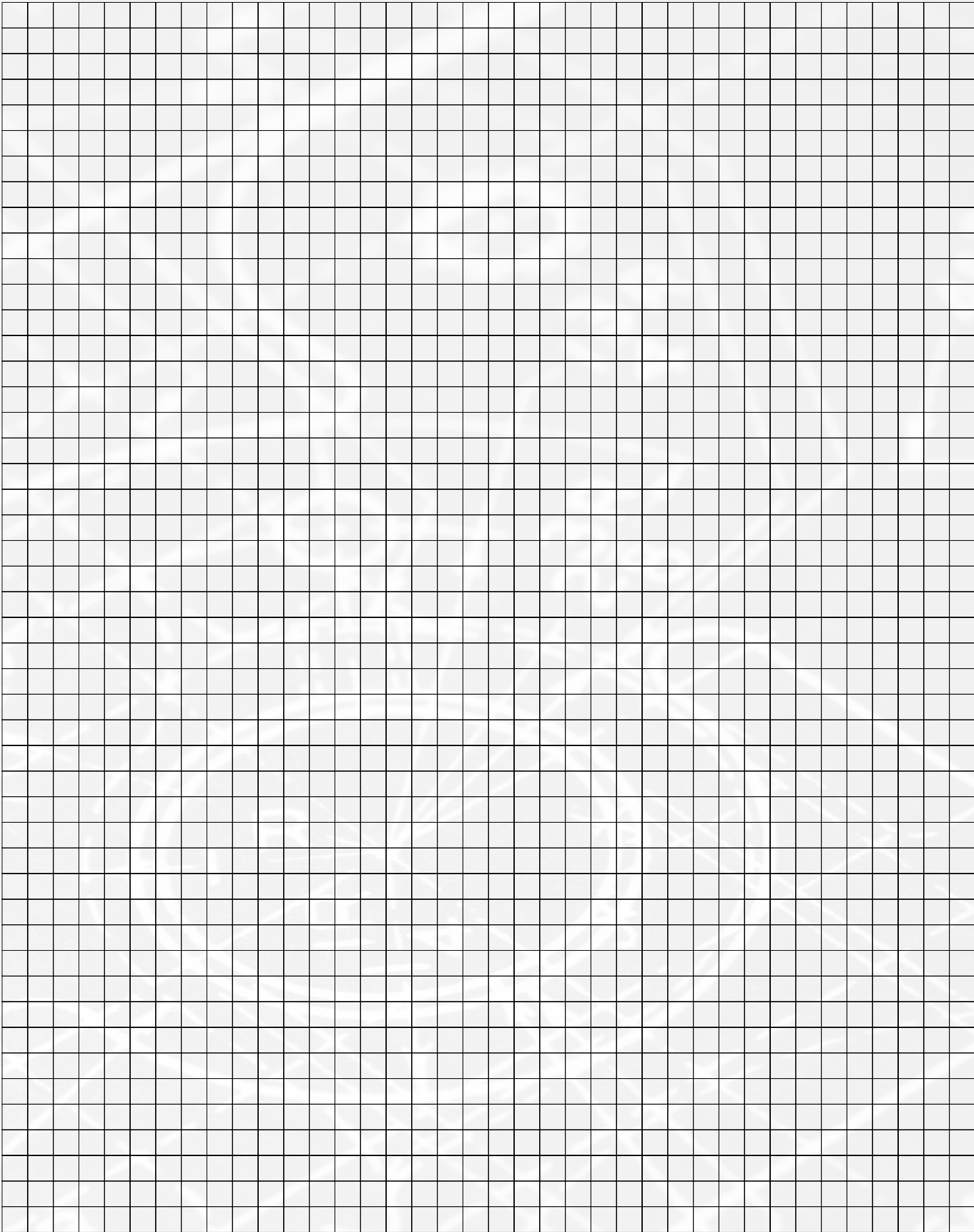
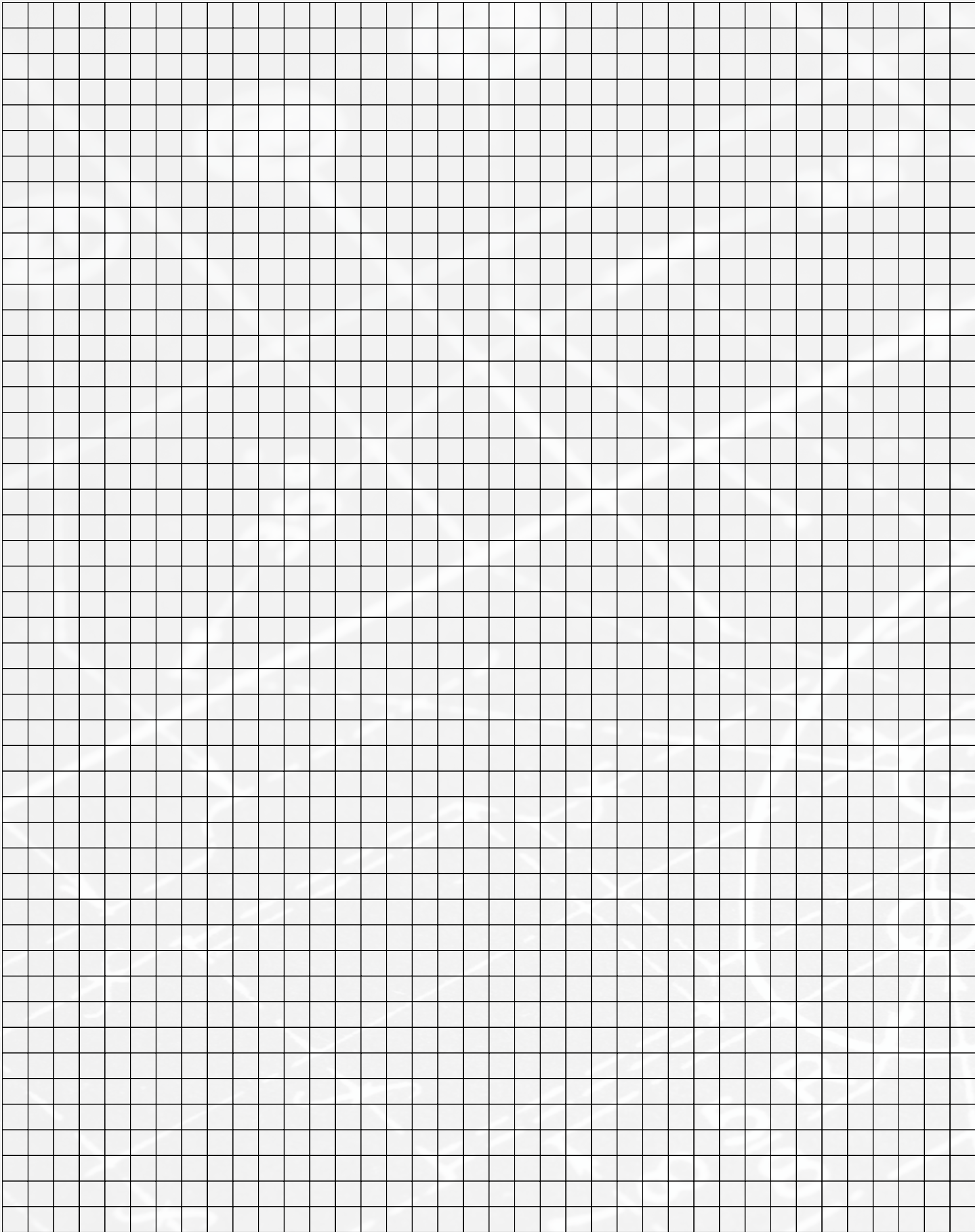

NOTES

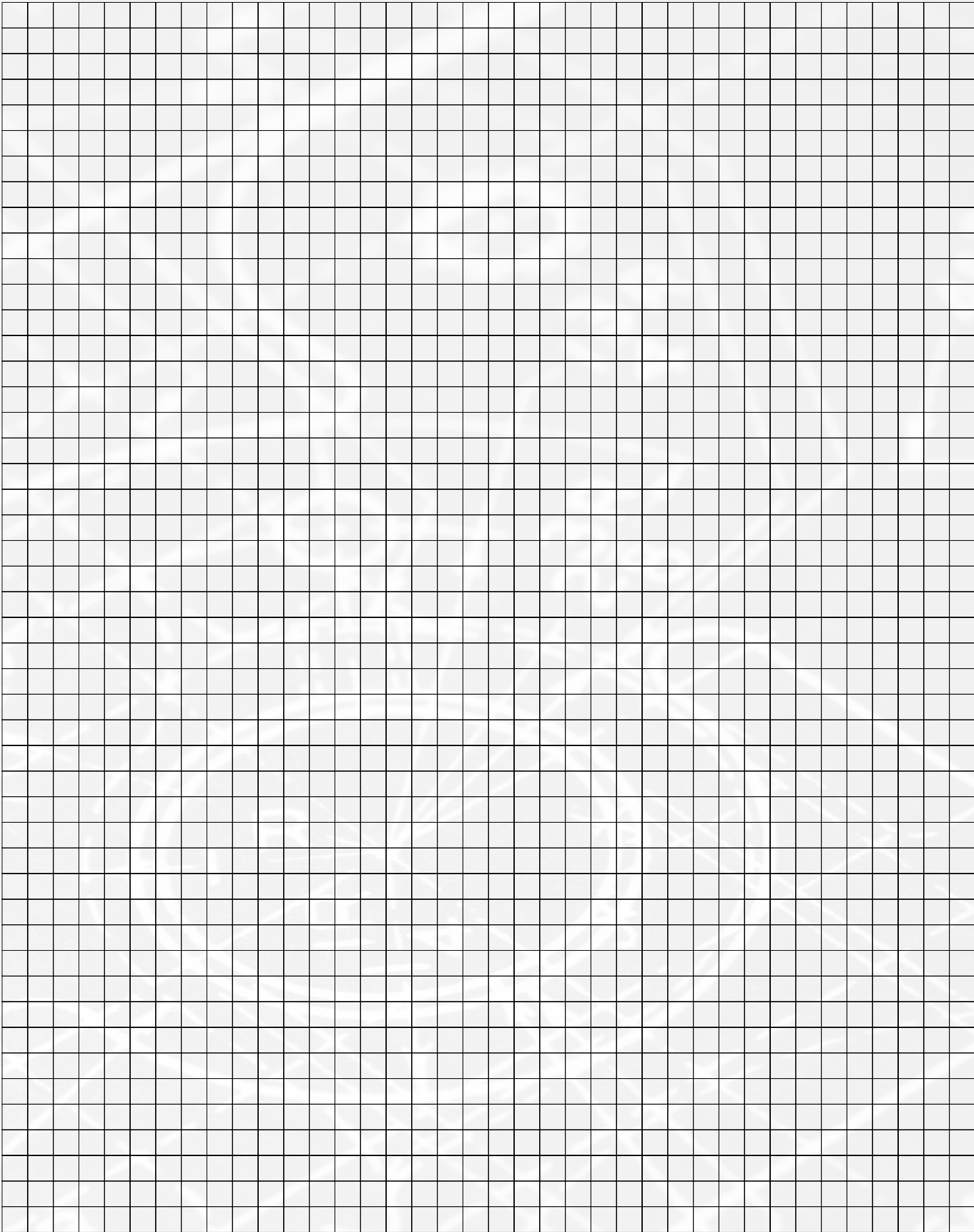
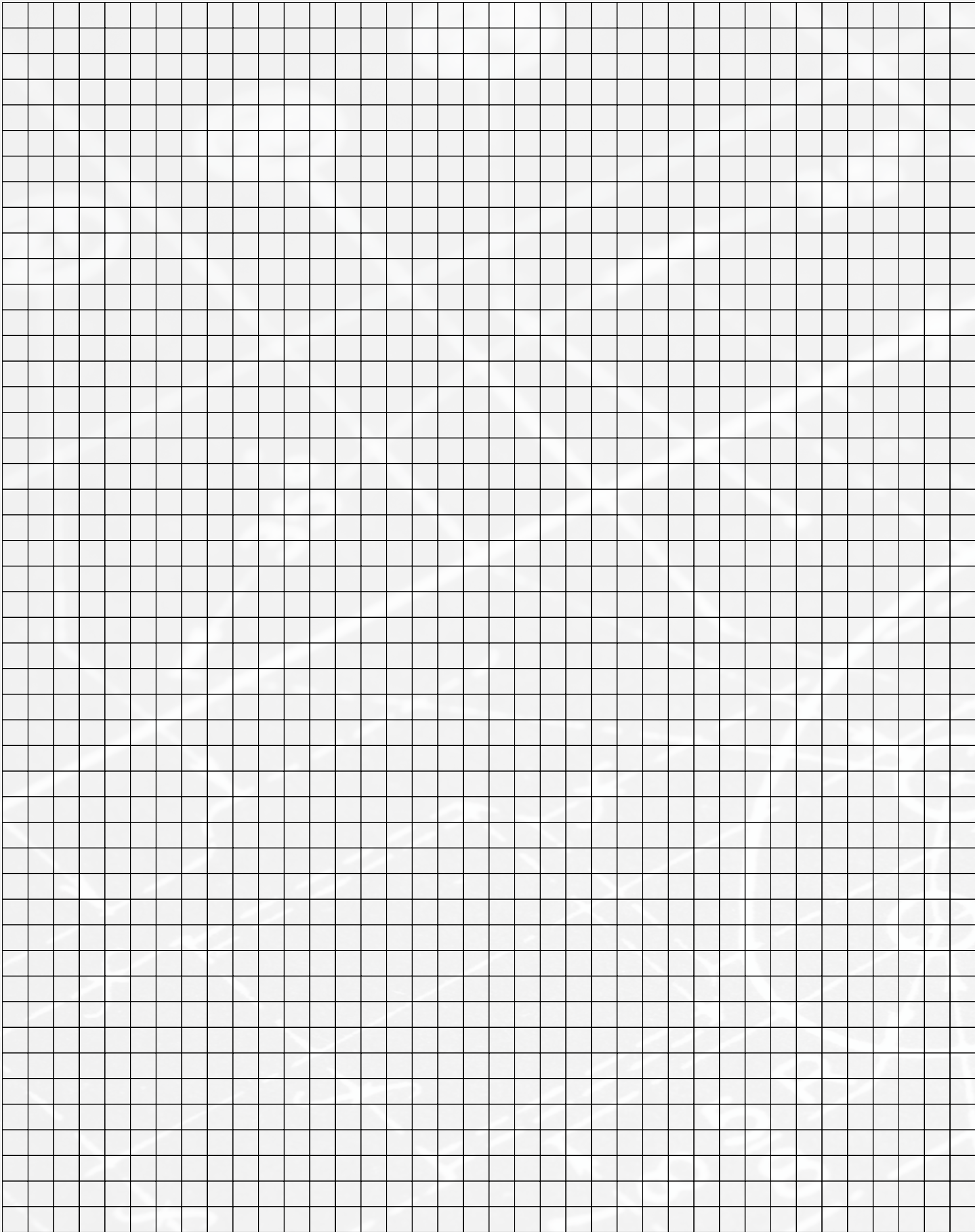

NOTES

